

TUBETTI

TUBES

TUBES

STAEBE

TUBOS

028.0001.130

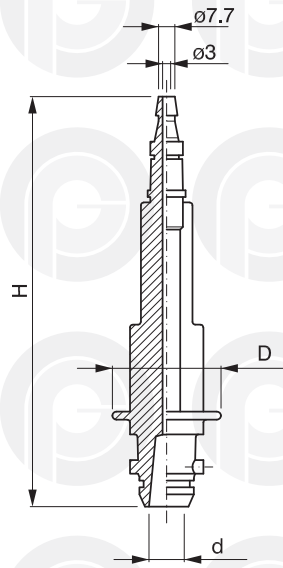
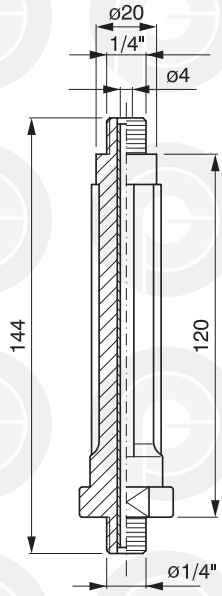

COD.	D	d	H
028.0010	40	13	153
028.0047	43,8	13,7	150

028.0013

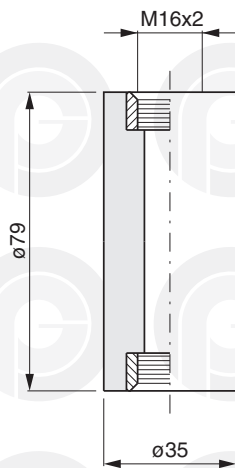

028.0014

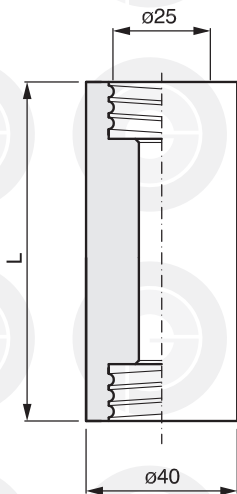
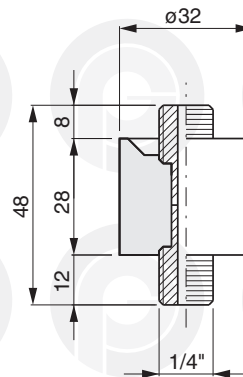

COD.	L
028.0015	150
028.0016	70
028.0017	36

028.0027

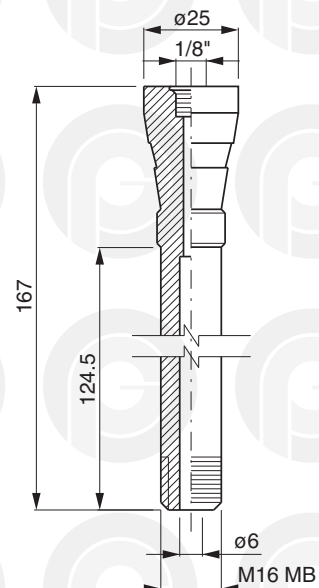

TUBETTI

TUBES

TUBES

STAEBE

TUBOS

028.0032

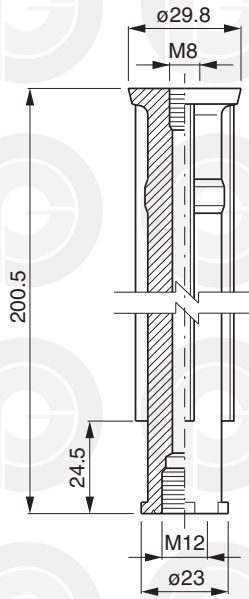

028.0037

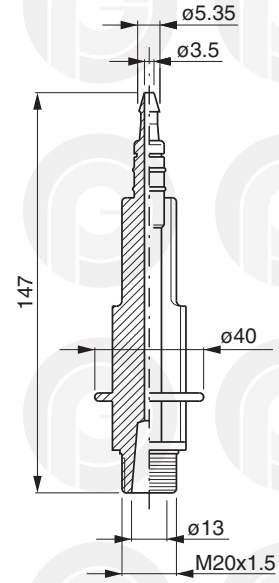

028.0038

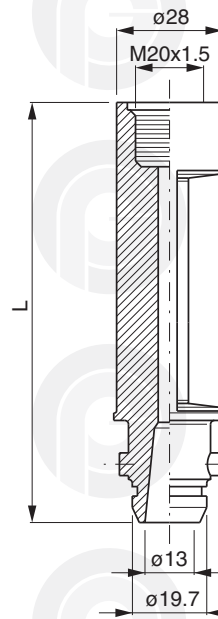
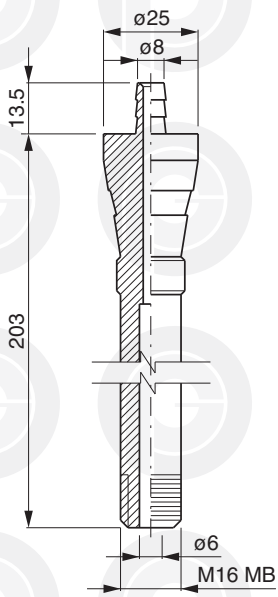

COD.	L
028.0035	77
028.0036	116.5

028.0044

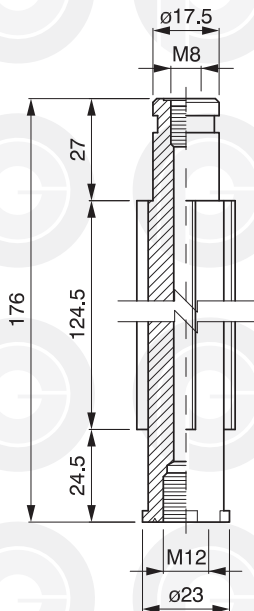

028.0048

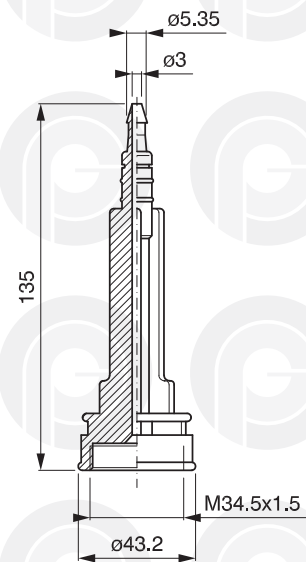

MOLLE

SPRINGS

RESSORTS

FEDERN

MUELLES

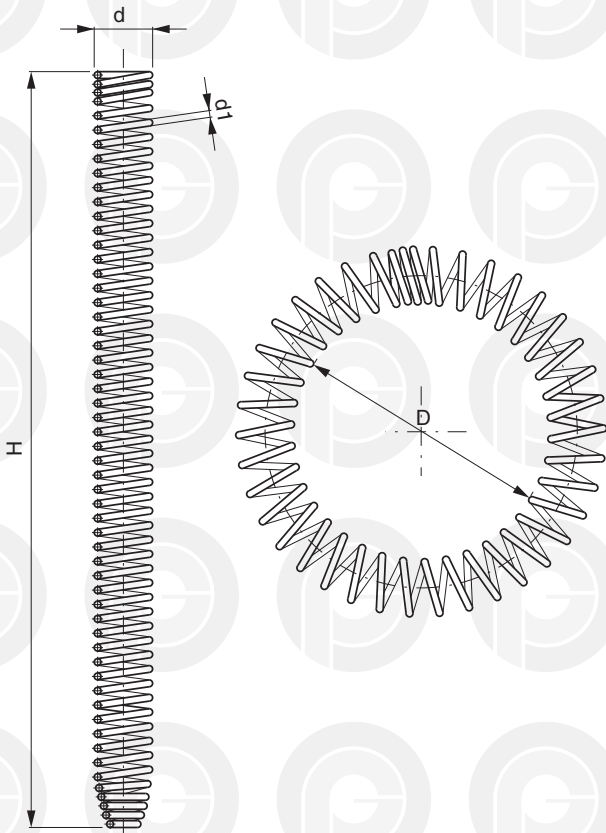

COD.	D	d	d1	H
029.0005	34	6	1	125
029.0004	35	7	1	137
029.0012	39	12	1.2	167
029.0003	45	9.9	1.2	177
029.0006	46	9.8	1.1	188
029.0016	46	9.1	1.2	185

TABELLA ACCOPPIAMENTO "TUBETTI + MOLLE"

"TUBE + SPRING" COUPLING TABLE TABLEAU DES ACCOUPLEMENTS « TUBES + RESSORTS » PAARUNGSTABELLE „LEITUNGEN + FEDERN“ TABLA ACOPLAMIENTO "TUBOS + MUELLES"

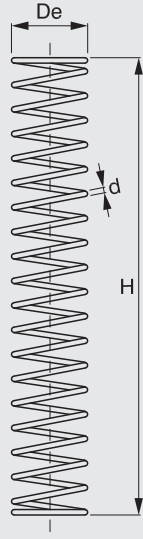
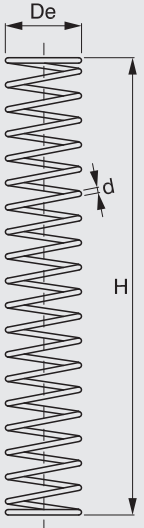
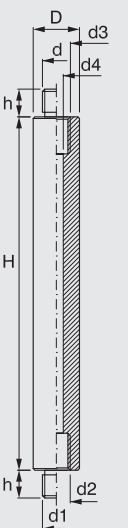
	TUBETTO TUBE TUBE LEITUNG TUBO									MOLLA "INOX" STAINLESS STEEL "SPRING" RESSORT « INOX » EDELSTAHLFEDER MUELLE "INOX"				
	Misure - Measures Mesures - Maße - Medidas									Materiale Material Materiel Werkstoff Material	Misure - Measures Mesures - Maße - Medidas			
	H	D	d	d1	d2	d3	d4	h			H	De	d <small>Filo Thread Fil Draht Hilo</small>	
COD.									COD.					
028.0001.105	118	20	1/4"	1/4"			6	11	AL	====>>	029.0001.110	140	29,4	2,2
											029.0002.110	140	29,5	3,0
028.0001.130	120	24	1/4"	1/4"				4	PA	====>>	029.0001.110	140	29,4	2,2
											029.0002.110	140	29,4	3,0
028.0002.105	230	20	1/4"	1/4"			6	11	AL	====>>	029.0013.110	245	28,2	2,2
											029.0014.110	245	29,5	3,0
028.0003.105	119	20	1/4"		3/8"		6	12	AL	====>>	029.0001.110	140	29,4	2,2
028.0004.105	101	20	1/4"	1/4"			6	12	AL	====>>	029.0038.110	80	29,5	3,0
028.0005.105	118	20	1/4"		10MA		6	12	AL	====>>	029.0001.110	140	29,4	2,2
028.0006.105	120	20	16MA	1/4"			6	12	AL	====>>	029.0001.110	140	29,4	2,2
028.0007.105	84	20		1/4"	10MA		6	12	AL	====>>	029.0018.110	97	30	2,2
028.0008.105	120	20		1/4"	12MA		6	12	AL	====>>	029.0001.110	140	29,4	2,2
028.0009.105	119	20		1/4"	1/4"		6	12	AL	====>>	029.0001.110	140	29,4	2,2
028.0010.136	152	27,5					3		PA	====>>	029.0008.110	128	35	2,0
028.00101.136	152	27,5					3		PA	====>>	029.0008.110	128	35	2,0
028.0011.105	121	25	M24	M18	1/4"		6	18	AL	====>>	029.0009.110	150	38,4	2,4
028.0019.105	118	20	1/4"	16MB			6	11	AL	====>>	029.0001.110	140	29,4	2,2
028.0020.105	113	20	1/4"	1/4"			6	12	AL	====>>	029.0001.110	140	29,4	2,2
028.0021.105	95	20		1/4"	10MA		6	11	AL	====>>	029.0007.110	115	28	1,5
028.0023.105	155	20	3/8"	1/4"			6	12	AL	====>>	029.0011.110	185	29,4	2,2
028.0024.105	62	20	1/4"	1/4"			6	12	AL	====>>	029.0017.110	60	29,4	2,2
028.0025.105	81	20	1/4"	1/4"			6	11	AL	====>>	029.0018.110	97	30	2,2
028.0026.105	76	20	1/4"	1/4"			6	12	AL	====>>	029.0018.110	97	30	2,2
028.0027.105	167	16	M16MB	1/8"			6	14	AL	====>>	029.0019.110	165	21,5	1,5
028.0027.01.105	190	16	M16MB	1/8"			6	14	AL	====>>	029.0019.110	165	21,5	1,5
028.0028.105	82	20	1/4"	1/4"			6	10	AL	====>>	029.0018.110	97	30	2,2
028.0030.105	92	20		1/4"	3/8"		6	12	AL	====>>	029.0018.110	97	30	2,2
028.0032.130	201	25,5	M8		M12		6,5		PA	====>>	029.0023.110	180	32	1,8
028.0033.105	118	20		1/4"	8MA		6	12	AL	====>>	029.0001.110	140	29,4	2,2
028.0034.105	87	20	1/4"	1/4"			6	12	AL	====>>	029.0018.110	97	30	2,2
028.0037.136	147	27,5		M20X1,5			3,5	13	PA	====>>	029.0008.110	128	35	2,0
028.0038.105	203	16		M16MB			6	11	AL	====>>	029.0019.110	165	21,5	1,5
028.0039.105	118	20	1/4"		8MA		6	12	AL	====>>	029.0001.110	140	29,4	2,2
028.0041.105	146,5	30	M24X1,5			1/8"	5	13	AL	====>>	029.0030.110	78,5	38	2,2
028.0043.105	150	20	1/4"	1/4"			6	12	AL	====>>	029.0011.110	185	29,4	2,2
028.0044.130	176	25,5			M8	M12	6	12	PA	====>>	029.0023.110	180	32	1,8
028.0047.130	150	31					3		PA	====>>	029.0032.110	117	40,5	2,0
028.0048.130	135	36			M34,5X1,5		3	10	PA	====>>	029.0008.110	128	35	2,2
028.0050.105	169	20	1/4"		M12		6	12	AL	====>>	029.0011.110	185	29,4	2,2
028.0051.105	224	20	1/4"	M16X1,5			6	12	AL	====>>	029.0013.110	245	28,2	2,2
028.0052.105	94,3	17,9	1/4"		M12		6	12	AL	====>>	029.0001.110	140	29,4	2,2

TABELLA ACCOPPIAMENTO "MOLLE + TUBETTI"

"SPRING + TUBE" COUPLING TABLE TABLEAU DES ACCOUPLEMENTS « RESSORTS + TUBES » PAARUNGSTABELLE „ FEDERN + LEITUNGEN “ TABLA ACOPLAMIENTO "MUELLES + TUBOS"

 MOLLA "INOX" STAINLESS STEEL "SPRING" RESSORT « INOX » EDELSTAHLFEDER MUELLE "INOX"	Misure - Measures Mesures - Maße - Medidas			 TUBETTO TUBE TUBE LEITUNG TUBO	Misure - Measures Mesures - Maße - Medidas								Materiale Material Material Werkstoff Material		
	H	De	d		H	D	d	d1	d2	d3	d4	h			
	COD.		Filo Thread Fil Draht Hilo		COD.										
029.0001.110	140	29,4	2,2	028.0001.130	120	24	1/4"	1/4"				4	12	PA	
				028.0001.105	118	20	1/4"	1/4"					6	11	AL
				028.0003.105	119	20	1/4"			3/8"			6	12	AL
				028.0005.105	118	20	1/4"			10MA			6	12	AL
				028.0006.105	120	20	16MA	1/4"					6	12	AL
				028.0008.105	120	20		1/4"		12MA			6	12	AL
				028.0009.105	119	20		1/4"		1/4"			6	12	AL
				028.0019.105	118	20	1/4"	16MB					6	11	AL
				028.0020.105	113	20	1/4"	1/4"					6	12	AL
				028.0033.105	118	20		1/4"		8MA			6	12	AL
				028.0039.105	118	20	1/4"			8MA			6	12	AL
				028.0052.105	94,3	17,9	1/4"			M12			6	12	AL
029.0002.110	140	29,5	3,0	028.0001.130	120	24	1/4"	1/4"			4	12	PA		
029.0007.110	115	28	1,5	028.0001.105	118	20	1/4"	1/4"			6	11	AL		
				028.0021.105	95	20		1/4"	10MA		6	11	AL		
029.0008.110	128	35	2,2	028.0010.136	152	27,5					3		PA		
				028.00101.136	152	27,5					3		PA		
				028.0037.136	147	27,5		M20X1,5		3,5	13	PA			
029.0009.110	150	38,4	2,4	028.0048.130	135	36			M34,5X1,5		3	10	PA		
				028.0011.105	121	25	M24	M18	1/4"	6	18	AL			
029.0011.110	185	29,4	2,2	028.0023.105	155	20	3/8"	1/4"			6	12	AL		
				028.0043.105	150	20	1/4"	1/4"		6	12	AL			
				028.0050.105	169	20	1/4"		M12	6	12	AL			
029.0013.110	245	28,2	2,2	028.0002.105	230	20	1/4"	1/4"			6	11	AL		
				028.0051.105	224	20	1/4"	M16X1,5		6	12	AL			
029.0014.110	245	29,5	3,0	028.0002.105	230	20	1/4"	1/4"			6	11	AL		
029.0017.110	60	29,4	2,2	028.0024.105	62	20	1/4"	1/4"			6	12	AL		
029.0018.110	97	30	2,2	028.0025.105	81	20	1/4"	1/4"			6	11	AL		
				028.0026.105	76	20	1/4"	1/4"		6	12	AL			
				028.0028.105	82	20	1/4"	1/4"		6	10	AL			
				028.0030.105	92	20		1/4"	3/8"	6	12	AL			
				028.0034.105	87	20	1/4"	1/4"		6	12	AL			
				028.0007.105	84	20		1/4"	10MA	6	12	AL			
				028.0027.105	167	16	M16MB	1/8"		6	14	AL			
029.0019.110	165	21,5	1,5	028.0027.01.105	190	16	M16MB	1/8"			6	14	AL		
				028.0038.105	203	16		M16MB		6	11	AL			
				028.0032.130	201	25,5	M8		M12	6,5		PA			
029.0023.110	180	32	1,8	028.0044.130	176	25,5			M8	M12	6	12	PA		
				028.0041.105	146,5	30	M24X1,5		1/8"	5	13	AL			
029.0030.110	78,5	38	2,2	028.0047.130	150	31				3		PA			
029.0032.110	117	40,5	2,0	028.0004.105	101	20	1/4"	1/4"			6	12	AL		