

SUPPORTI PER VENTOSE

SUCKER FITTING

SUPPORT POUR VENTOUSE

SAUGERTRÄGER

SOPORTE POR VENTOSA

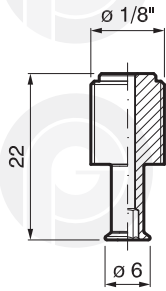

023.0001

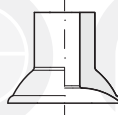

003.0009
003.0010
003.0011
003.0031

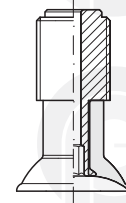

005.0019
005.0020
005.0021
005.0022

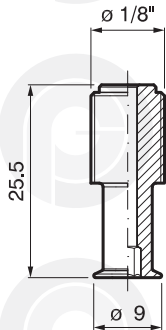

023.0002

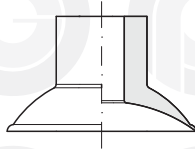

003.0014
003.0016

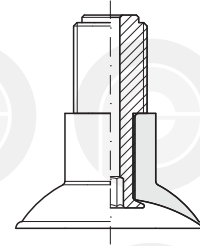

005.0007
005.0008

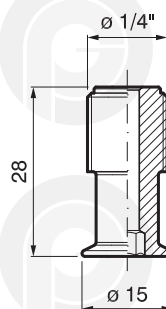

023.0003

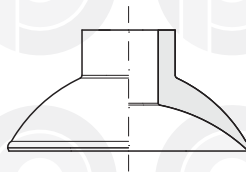

003.0018
003.0064
003.0019

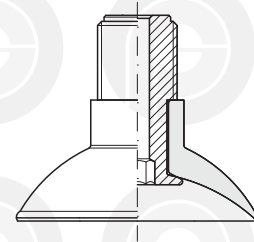

005.0009
005.0033
005.0010

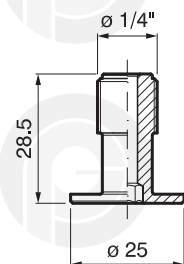

023.0004

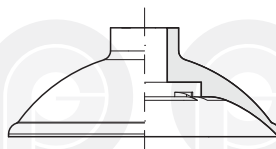

003.0045
003.0020
003.0039

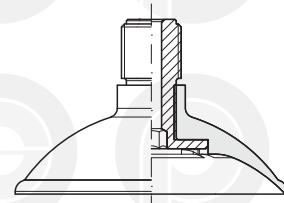

005.0028
005.0011
005.0029

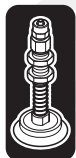
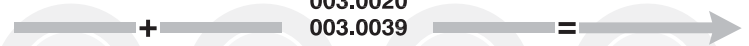

SUPPORTI PER VENTOSE

SUCKER FITTING

SUPPORT POUR VENTOUSE

SAUGERTRÄGER

SOPORTE POR VENTOSA

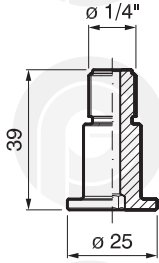

023.0005

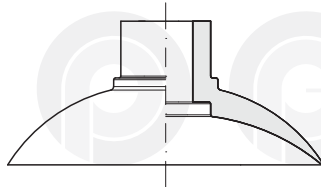

003.0021

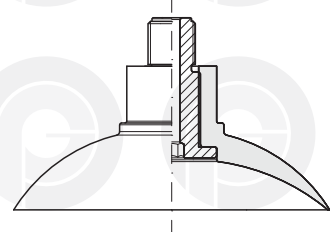

005.0012

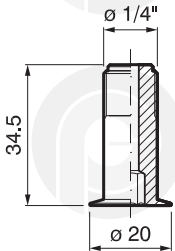

023.0007

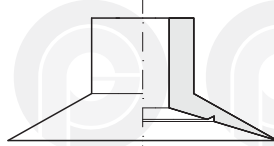

006.0040
006.0042

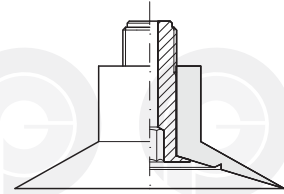

008.0026
008.0027

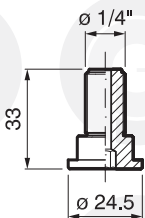

023.0008

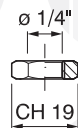

023.1004

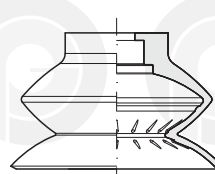

012.0019

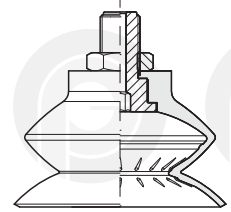

014.0010

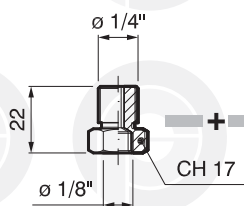

023.0010

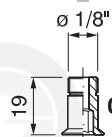

023.0009

006.0051
006.0052



008.0028
008.0029

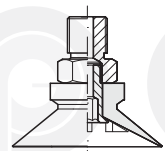

012.0058
012.0098
012.0103
012.0088
012.0089



014.0024
014.0026
014.0023
014.0029
014.0030

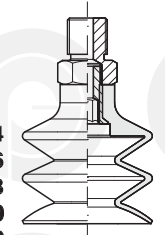

SUPPORTI PER VENTOSE

SUCKER FITTING

SUPPORT POUR VENTOUSE

SAUGERTRÄGER

SOPORTE POR VENTOSA

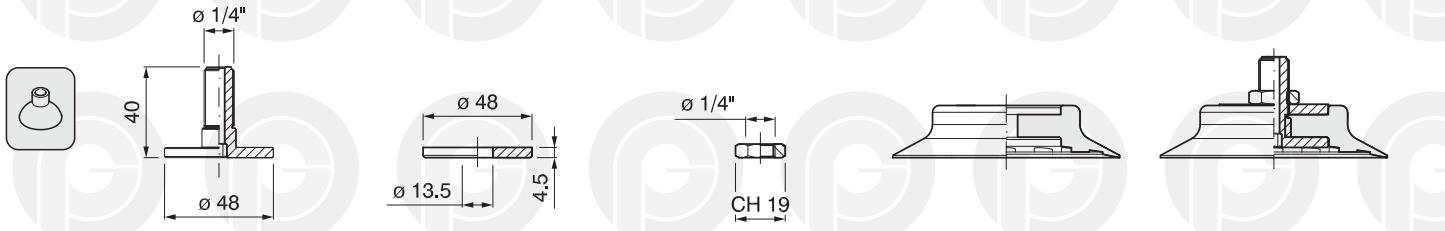

023.0011 + **023.0012** + **023.1004** + **006.0041** = **008.0030**

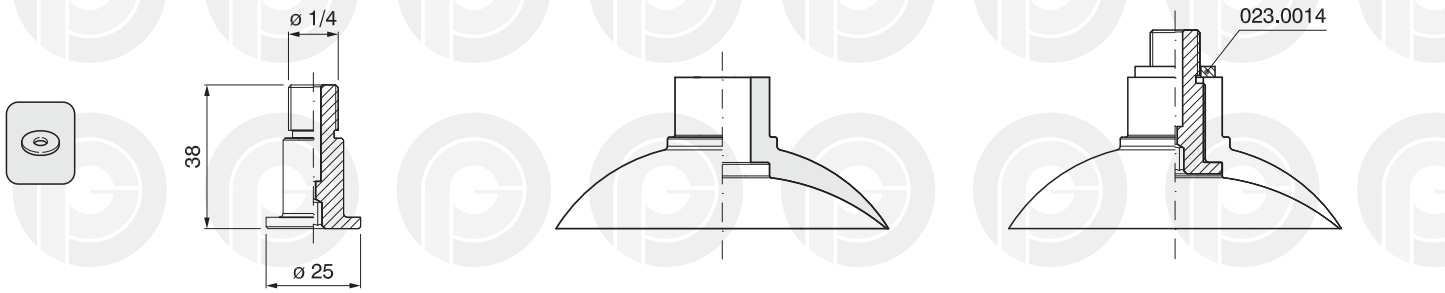

023.0013 + **003.0021** = **005.0026**

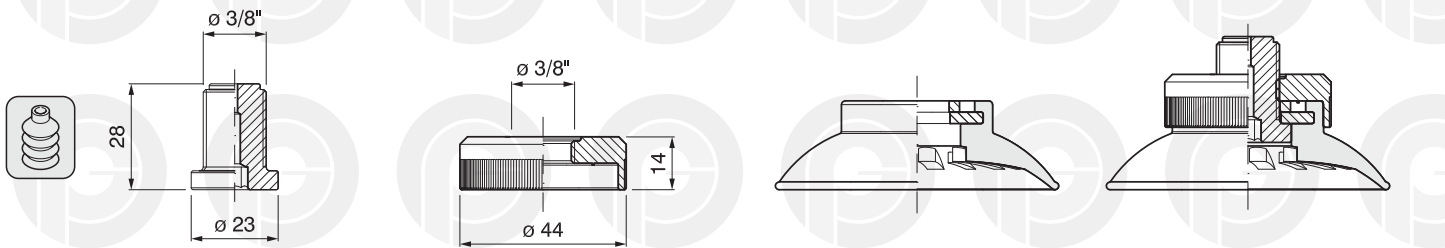

023.0015 + **023.0658** + **003.0042** = **005.0027**

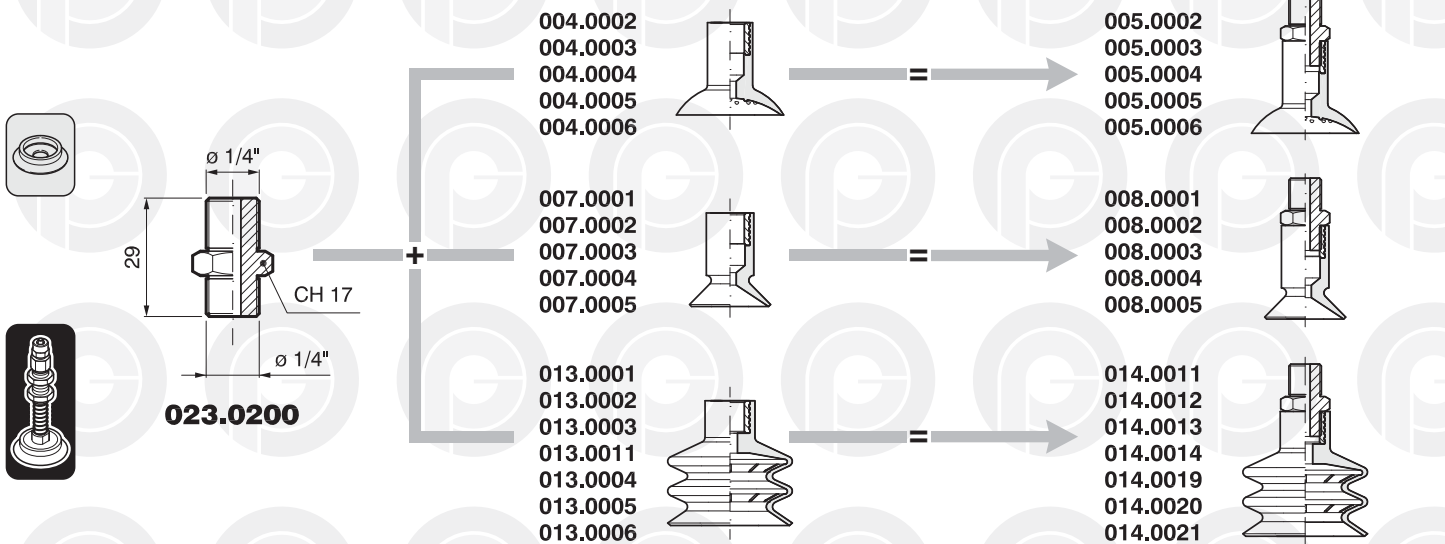

SUPPORTI PER VENTOSE

SUCKER FITTING

SUPPORT POUR VENTOUSE

SAUGERTRÄGER

SOPORTE POR VENTOSA

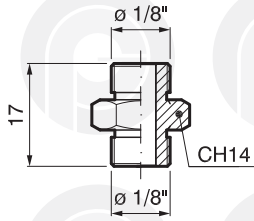

023.0201

+

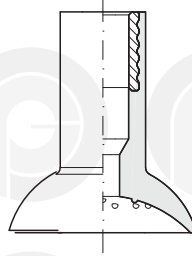

004.0001

=

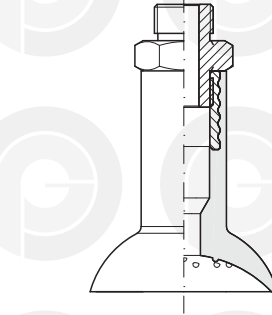

005.0001

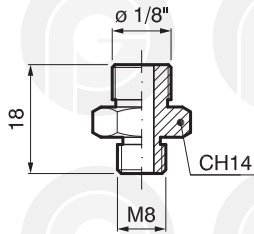

023.0202

+

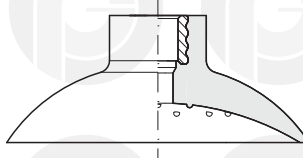

004.0007

=

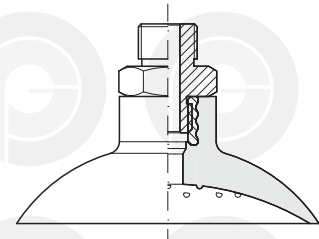

005.0013

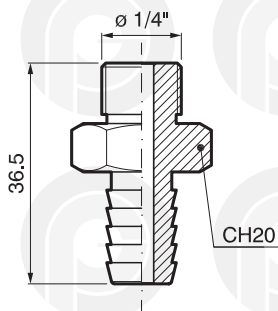

023.0205

+

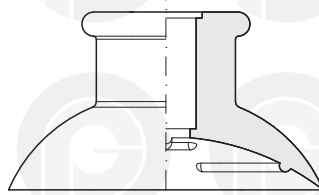

003.0023

=

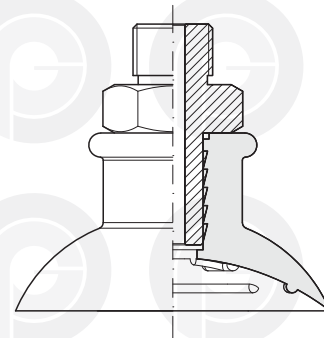

005.0023

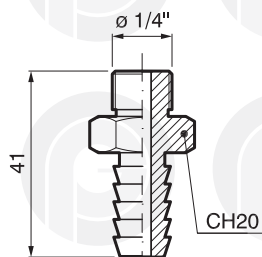

023.0206

+

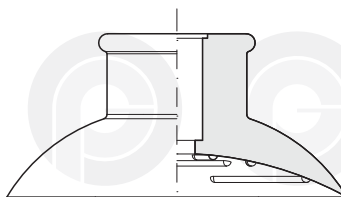

003.0022

=

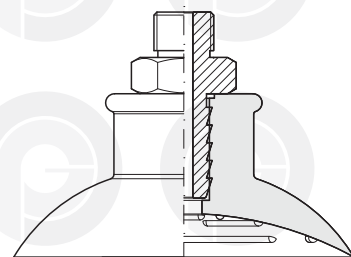

005.0024



SUPPORTI PER VENTOSE

SUCKER FITTING

SUPPORT POUR VENTOUSE

SAUGERTRÄGER

SOPORTE POR VENTOSA

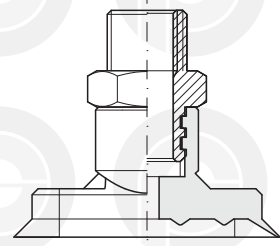
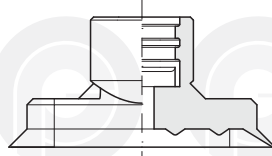
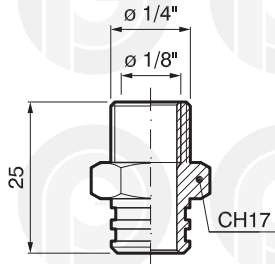

006.0121
006.0122
006.0123
006.0124
006.0125

006.0231
006.0232
006.0233
006.0234
006.0235

023.0207

+

=

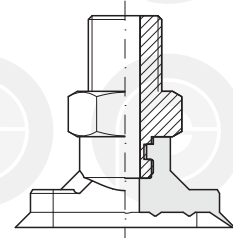
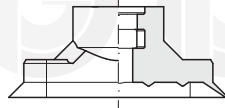
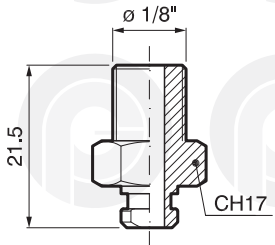

006.0116
006.0117
006.0118
006.0119
006.0120

006.0226
006.0227
006.0228
006.0229
006.0230

023.0209

+

=

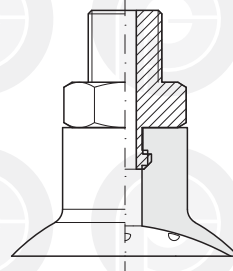
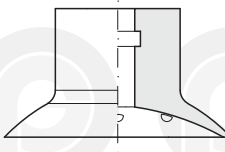
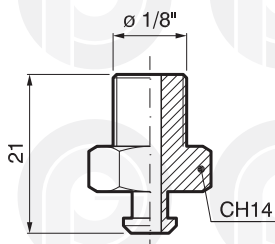

023.0211

+

003.0060

=

005.0030

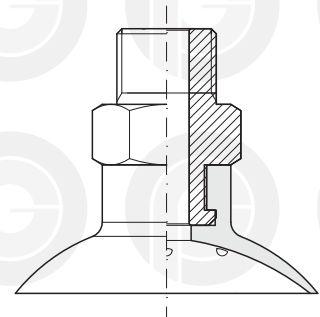
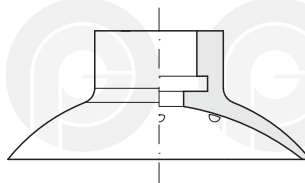
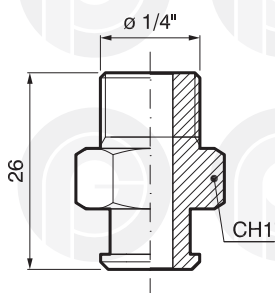

023.0212

+

003.0061
003.0062

=

005.0032
005.0031

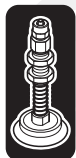

SUPPORTI PER VENTOSE

SUCKER FITTING

SUPPORT POUR VENTOUSE

SAUGERTRÄGER

SOPORTE POR VENTOSA

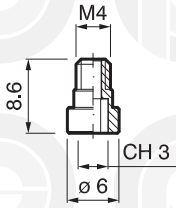

023.0217



023.0218



012.0154

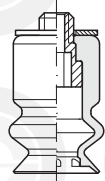

014.0027

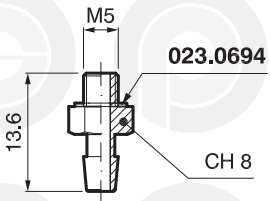

023.0300

006.0053
006.0095
006.0096



008.0006
008.0034
008.0035

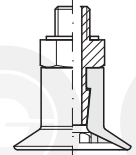

006.0107



008.0042

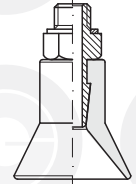

012.0009
012.00091
012.0010
012.0135
012.0140



014.0001
014.00012
014.0002

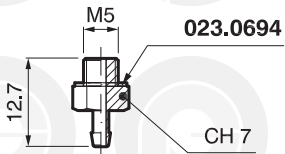
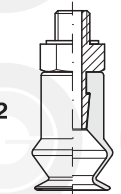

023.0302

006.0092
006.0093
006.0094



012.0078



008.0031
008.0032
008.0033



006.0054
006.0055
006.0056
006.0097
006.0098

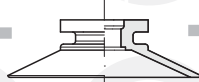

008.0007
008.0008
008.0009
008.0037
008.0039

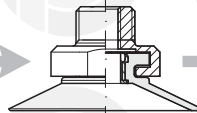

023.0580

008.0021
008.0040

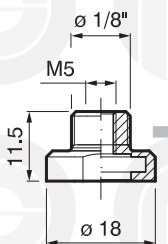
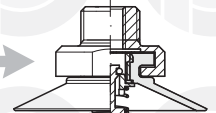

023.0600

023.0550

023.0800

006.0108
006.0109

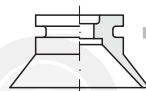

008.0044
008.0046

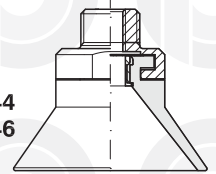

012.0011
012.0012
012.0063

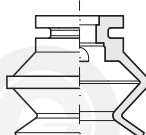

014.0003
014.0004
013.0014

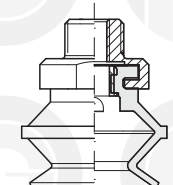

SUPPORTI PER VENTOSE

SUCKER FITTING

SUPPORT POUR VENTOUSE

SAUGERTRÄGER

SOPORTE POR VENTOSA

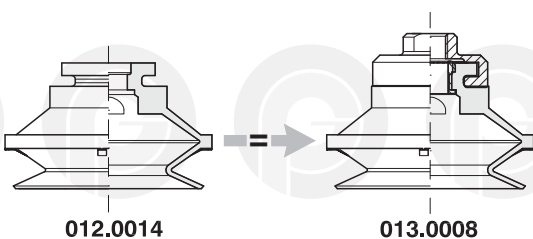
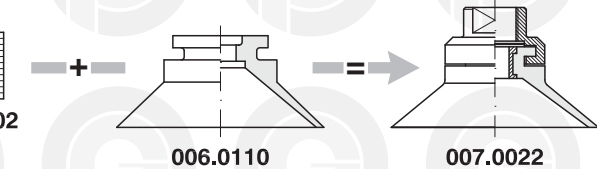
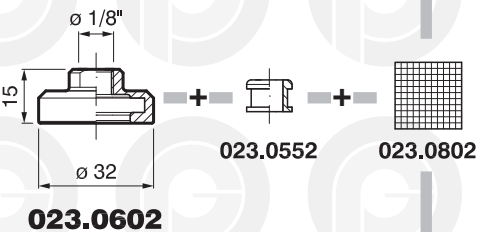
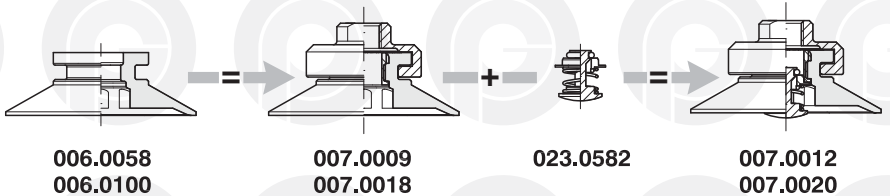
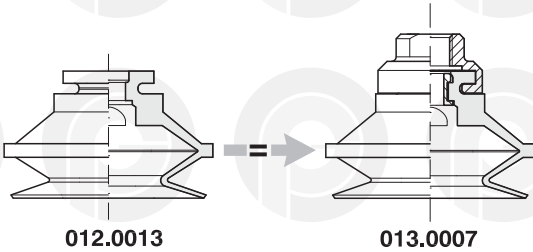
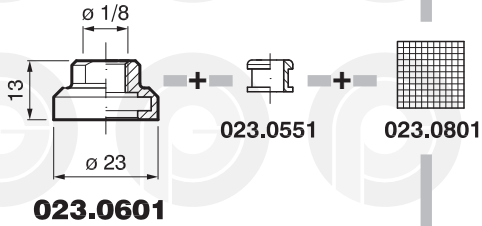
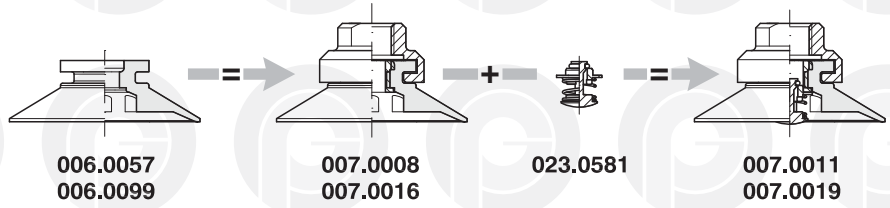

SUPPORTI PER VENTOSE

SUCKER FITTING

SUPPORT POUR VENTOUSE

SAUGERTRÄGER

SOPORTE POR VENTOSA

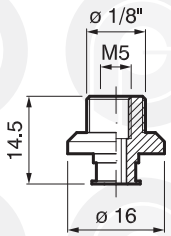

023.0606

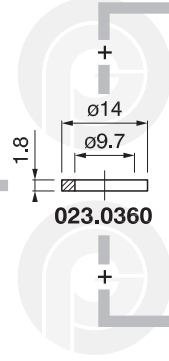

023.0360

006.0054
006.0055
006.0056
006.0097
006.0098
006.0108
006.0109
006.0158

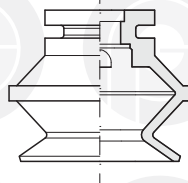
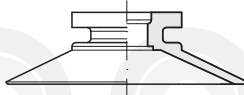

012.0011
012.0012

008.0023
008.0024
008.0025
008.0036
008.0038
008.0043
008.0045
008.0047

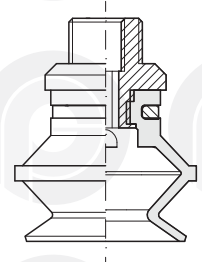
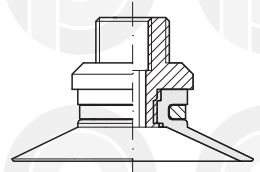

014.0017
014.0018

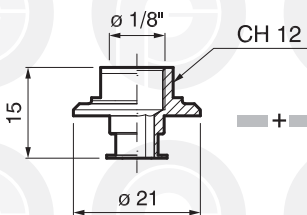

023.0607

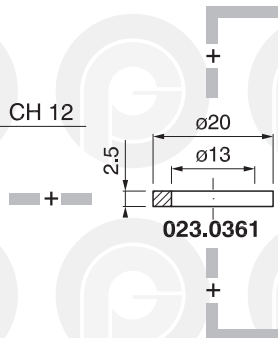

023.0361

006.0057
006.0099

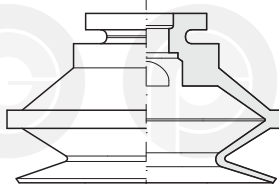
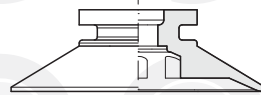

012.0013



007.0013
007.0015

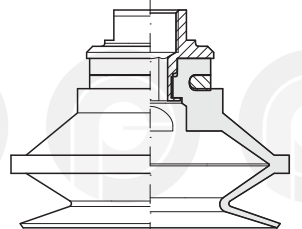

013.0024

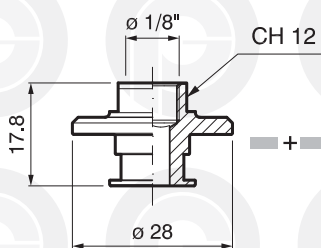

023.0608

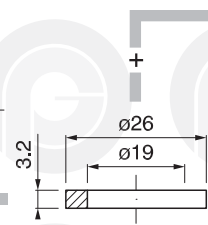

023.0362

006.0058
006.0100
006.0110

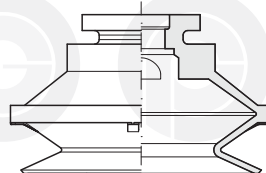
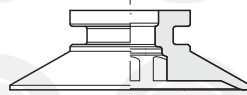

012.0014



007.0014
007.0017
007.0021

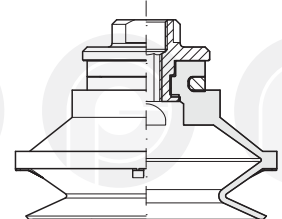

013.0025



SUPPORTI PER VENTOSE

SUCKER FITTING

SUPPORT POUR VENTOUSE

SAUGERTRÄGER

SOPORTE POR VENTOSA

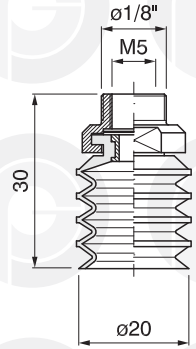
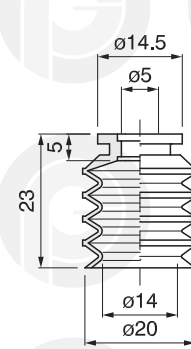
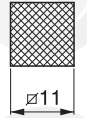
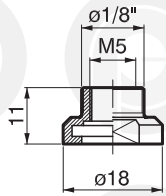

023.0600 + **023.0550** + **023.0800** + **023.0370** + **012.0063** = **013.0014**

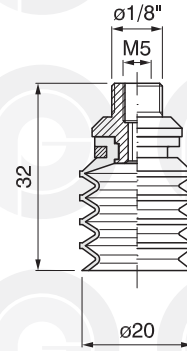
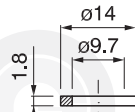
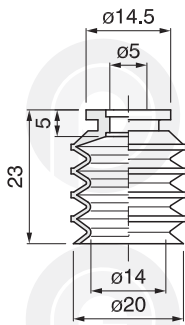
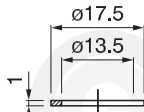
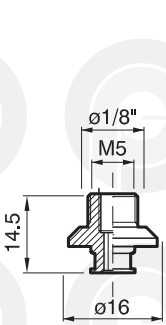

023.0606 + **023.0370** + **012.0063** + **023.0360** = **013.0020**

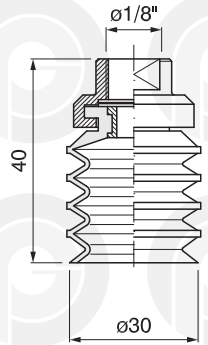
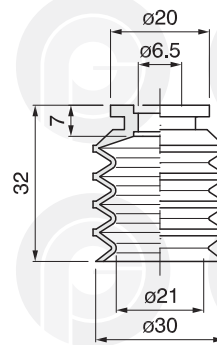
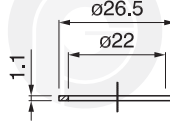
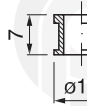
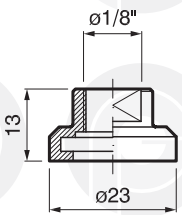

023.0601 + **023.0551** + **023.0801** + **023.0371** + **012.0064** = **013.0015**

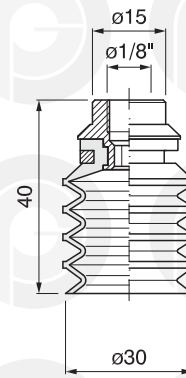
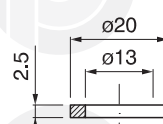
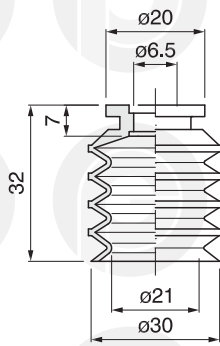
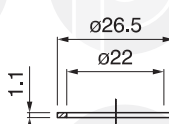
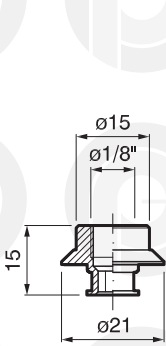

023.0607 + **023.0371** + **012.0064** + **023.0361** = **013.0021**

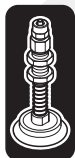

SUPPORTI PER VENTOSE

SUCKER FITTING

SUPPORT POUR VENTOUSE

SAUGERTRÄGER

SOPORTE POR VENTOSA

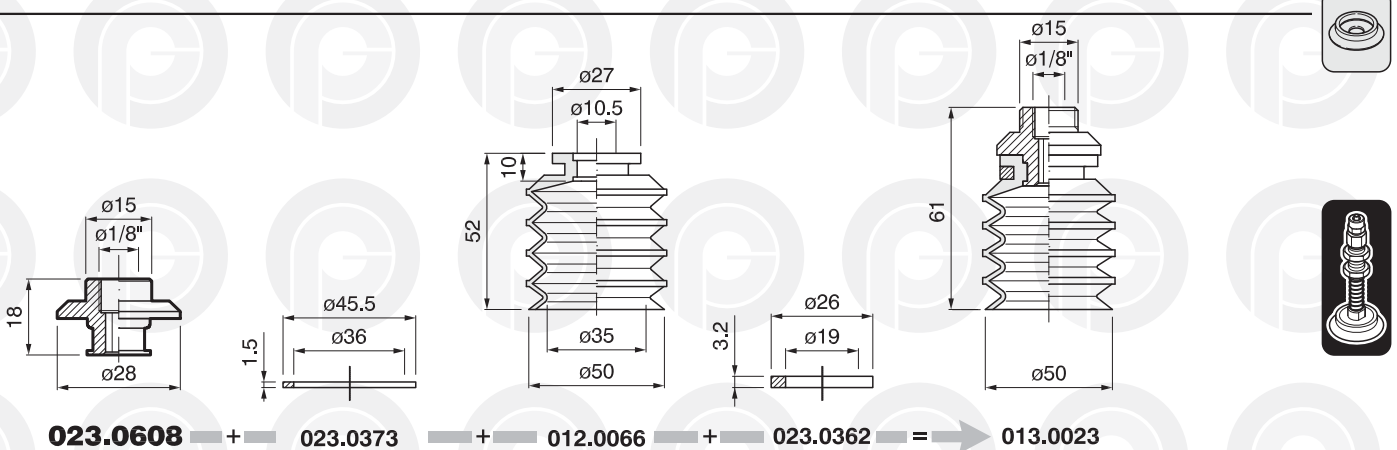
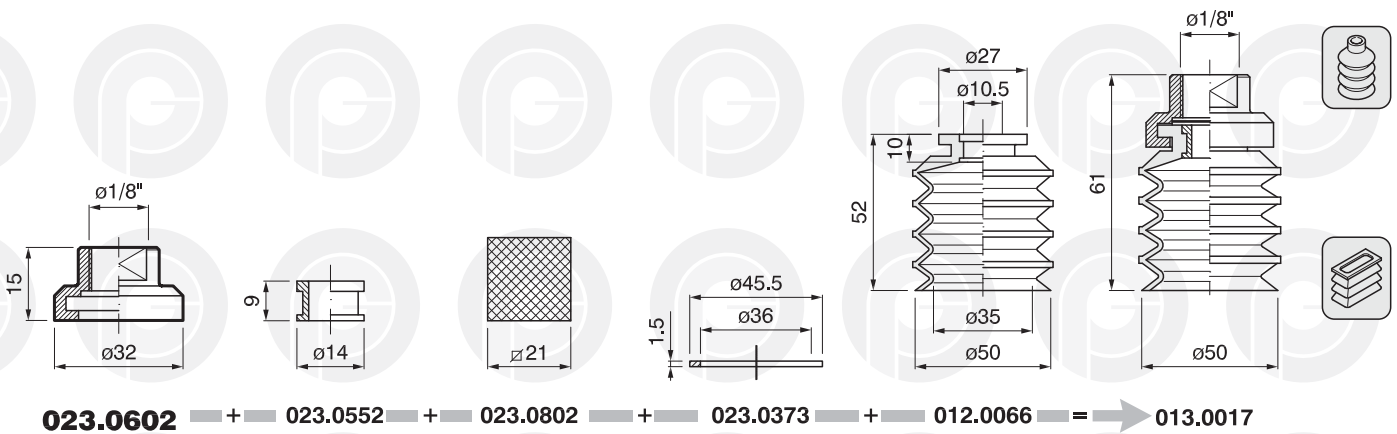
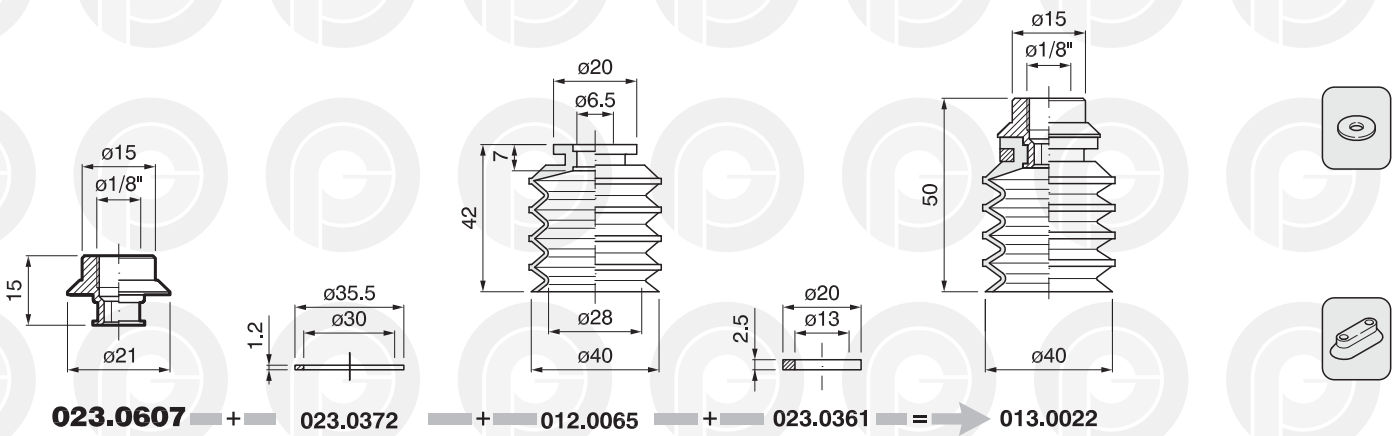
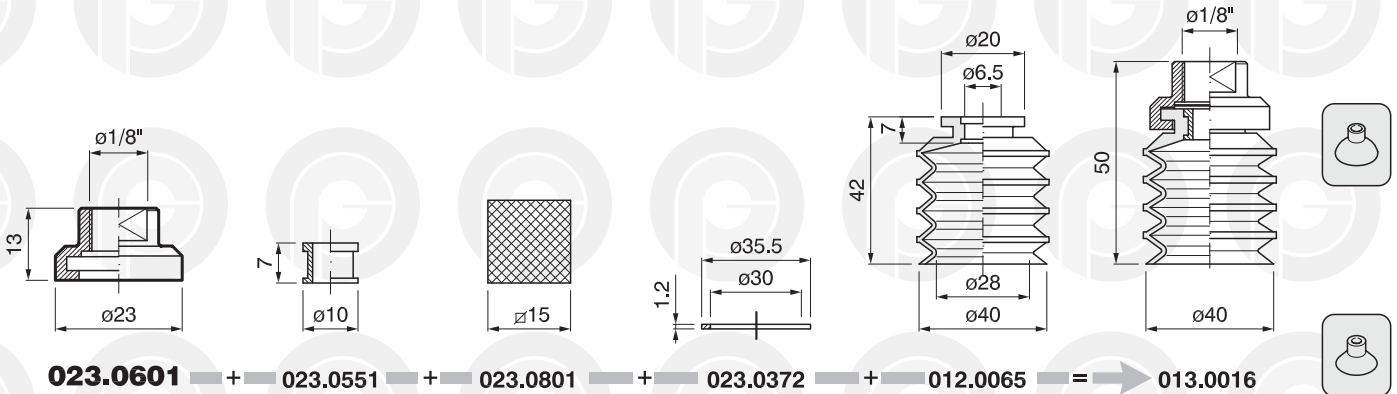

SUPPORTI PER VENTOSE

SUCKER FITTING

SUPPORT POUR VENTOUSE

SAUGERTRÄGER

SOPORTE POR VENTOSA

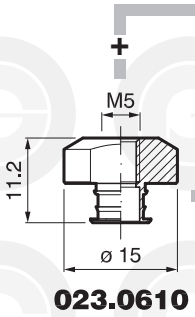

023.0610



023.0580

023.0563

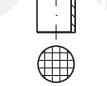

023.0808

023.0574



023.0575

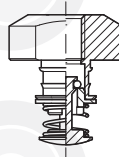

023.0649

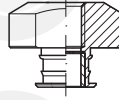

023.0611

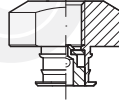

023.0612

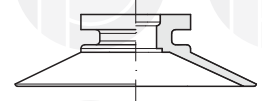

006.0054 - 006.0055
006.0056 - 006.0097
006.0098 - 006.0108
006.0109 - 006.0158

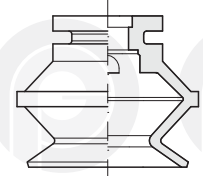

012.0011 - 012.0012

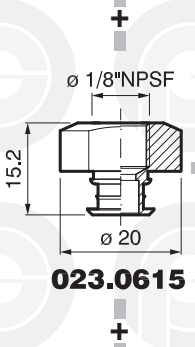

023.0615



023.0581

023.0564

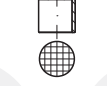

023.0809

023.0572



023.0573

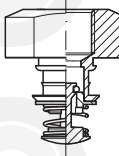

023.0648

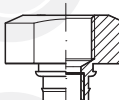

023.0616

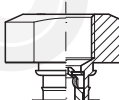

023.0617

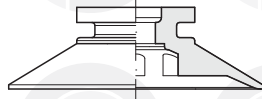

006.0057 - 006.0099

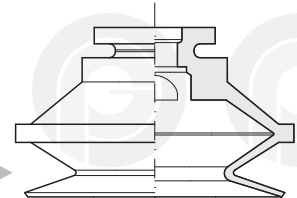

012.0013

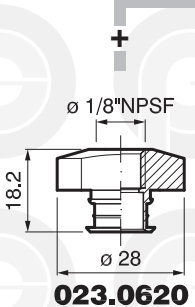

023.0620



023.0582

023.0565

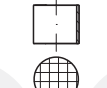

023.0810

023.0570



023.0571

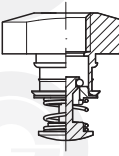

023.0645

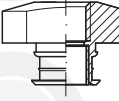

023.0621

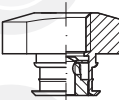

023.0622

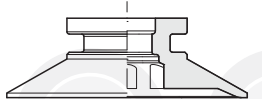

006.0058 - 006.0100
006.0110

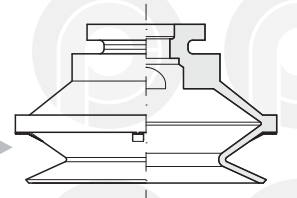

012.0014

SUPPORTI PER VENTOSE

SUCKER FITTING

SUPPORT POUR VENTOUSE

SAUGERTRÄGER

SOPORTE POR VENTOSA

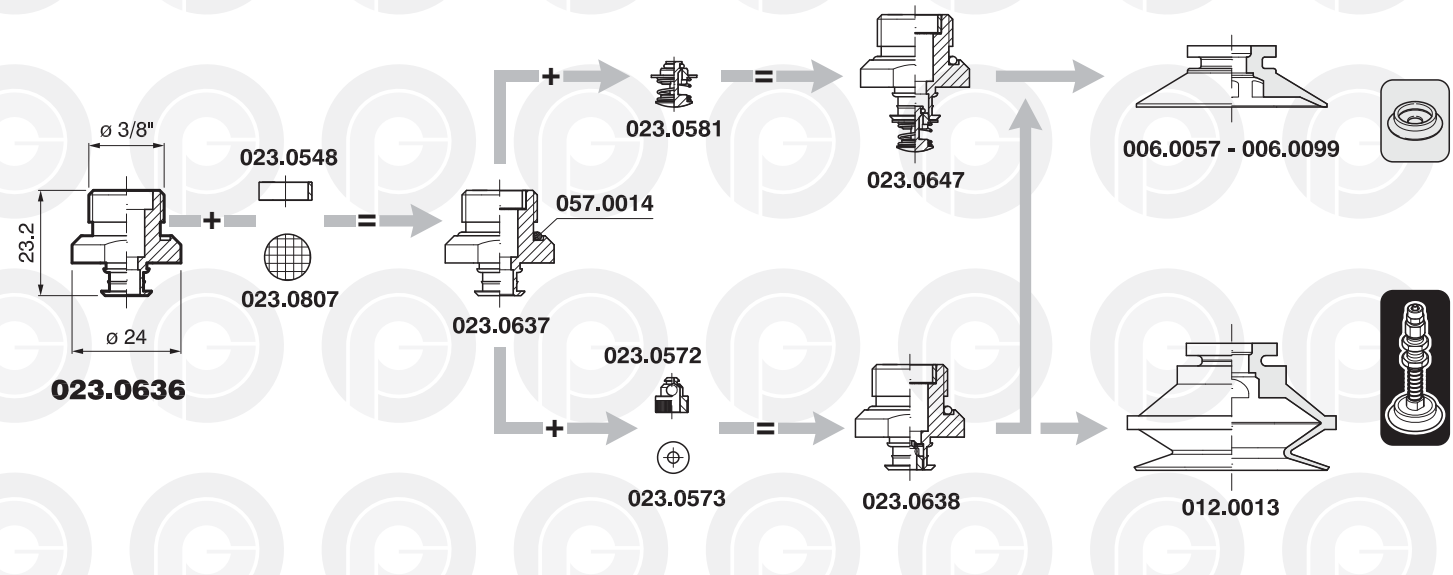
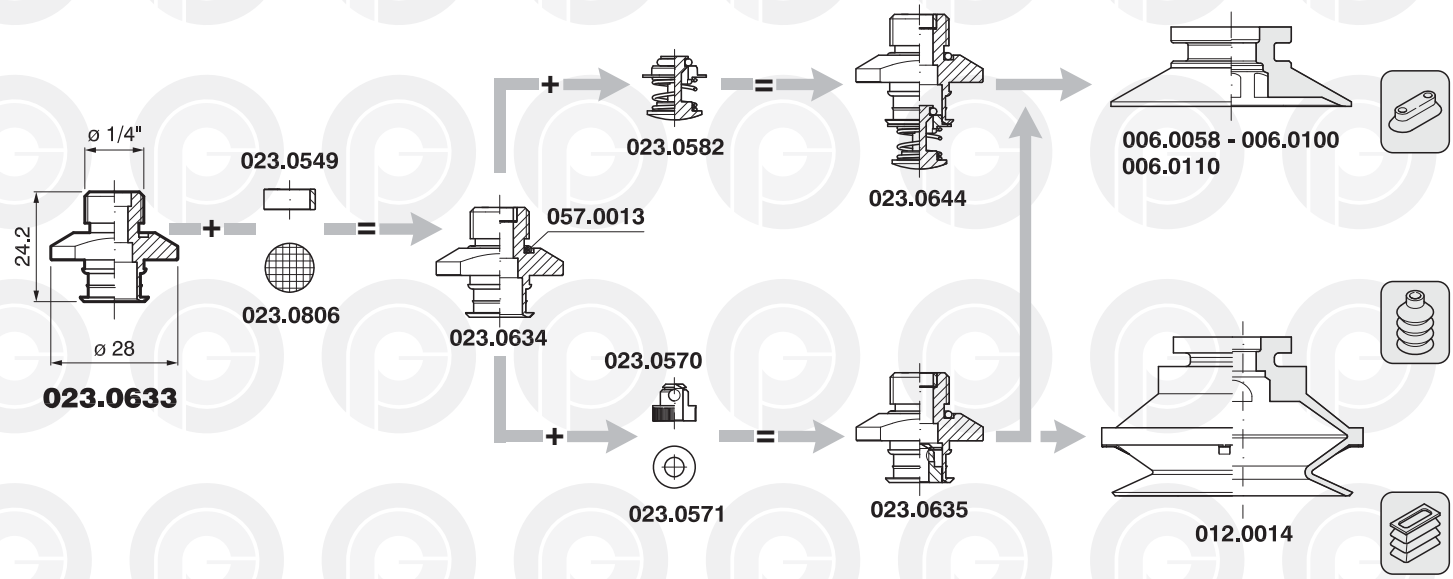
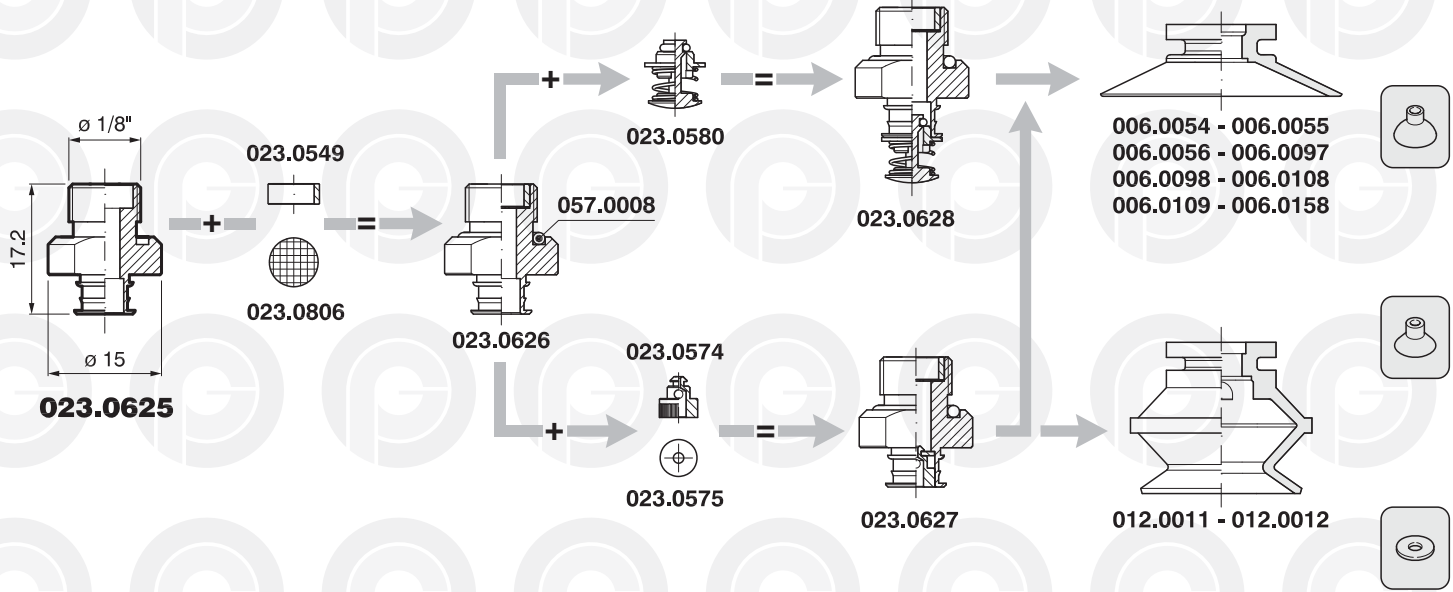

SUPPORTI PER VENTOSE

SUCKER FITTING

SUPPORT POUR VENTOUSE

SAUGERTRÄGER

SOPORTE POR VENTOSA

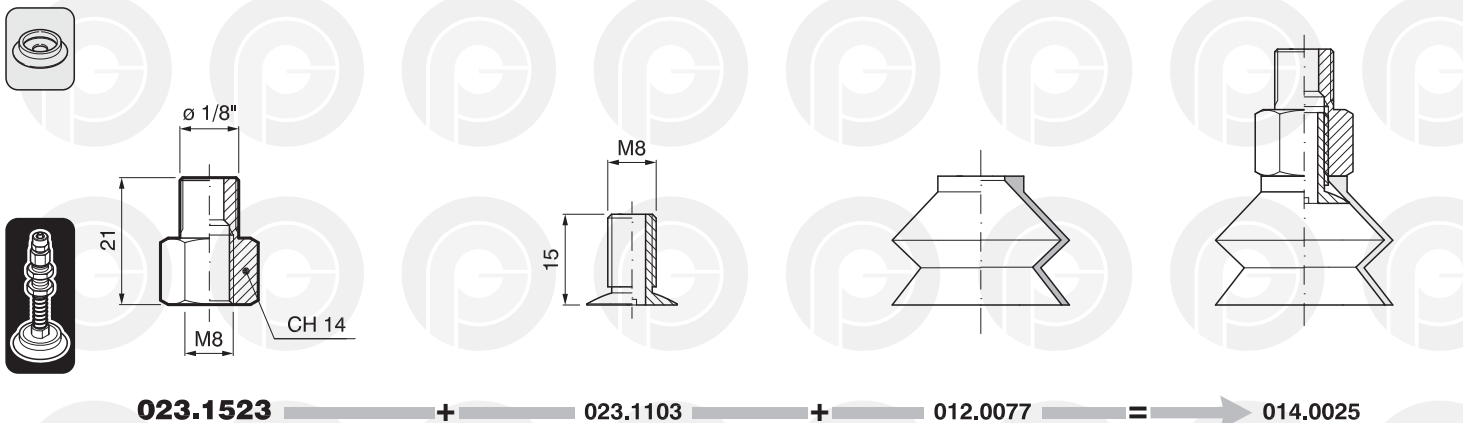
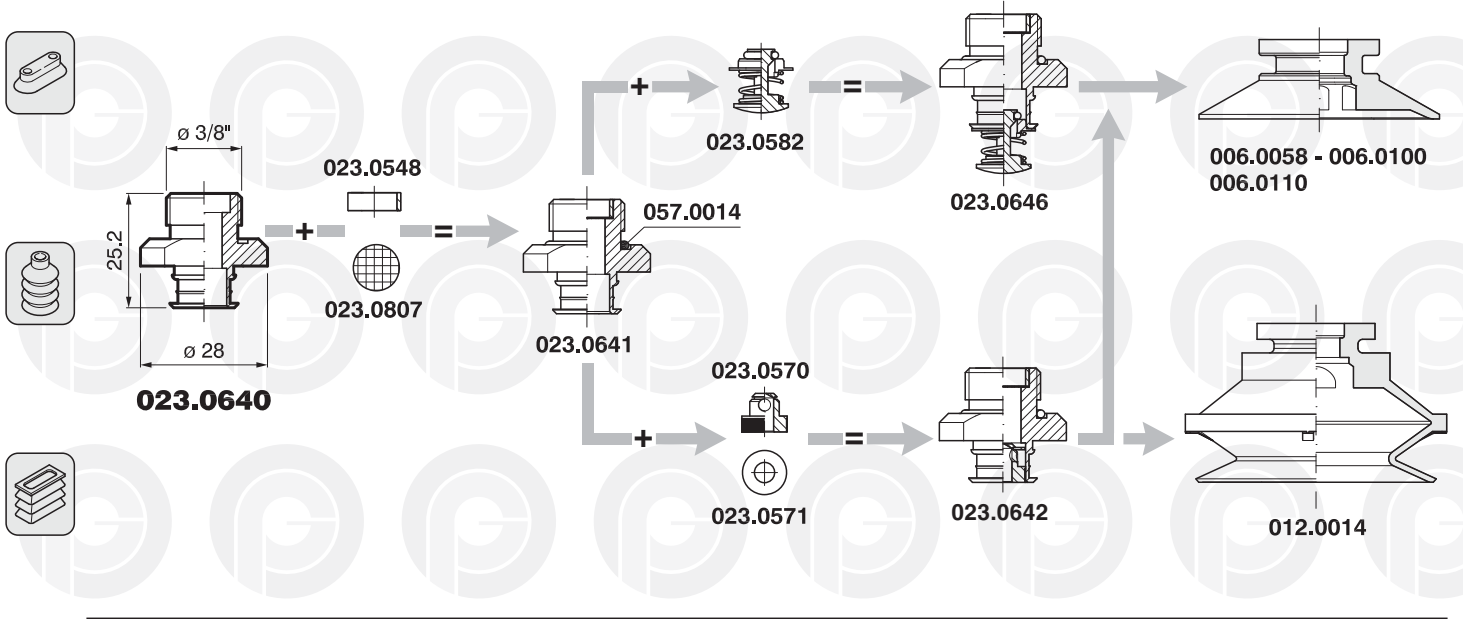
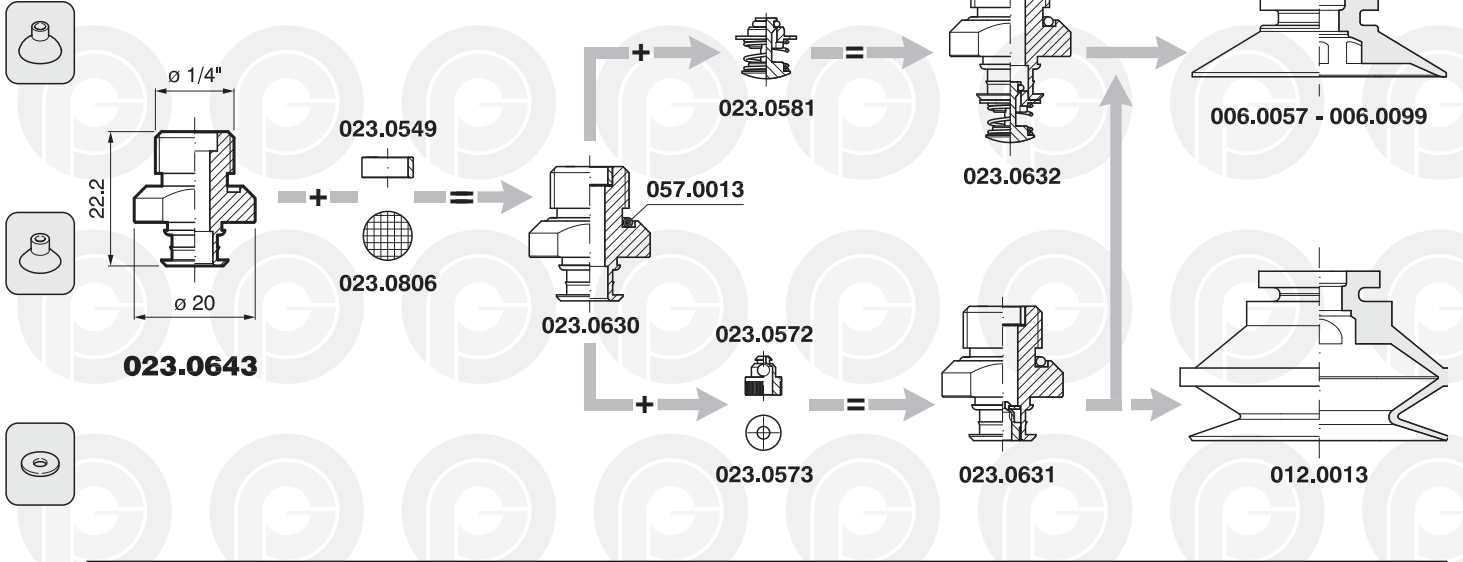

SUPPORTI PER VENTOSE

SUCKER FITTING

SUPPORT POUR VENTOUSE

SAUGERTRÄGER

SOPORTE POR VENTOSA

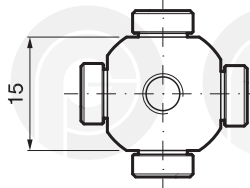
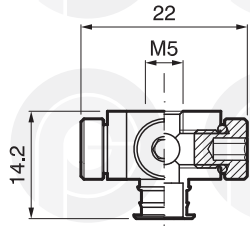

023.0681

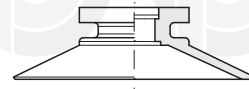

006.0054 - 006.0055
006.0056 - 006.0097
006.0098 - 006.0108
006.0109 - 006.0158

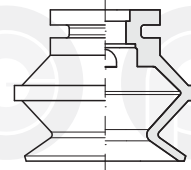

012.0011 - 012.0012

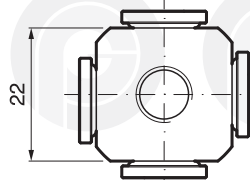
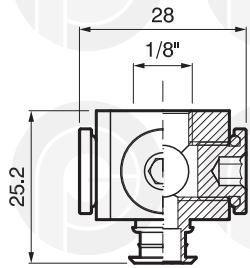

023.0683

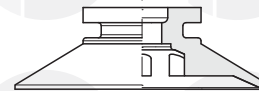

006.0057 - 006.0099

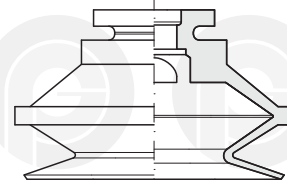

012.0013

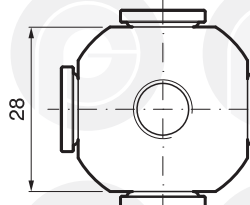
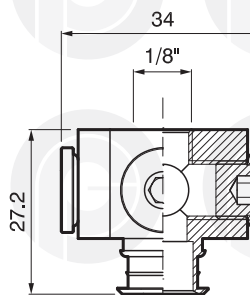

023.0685

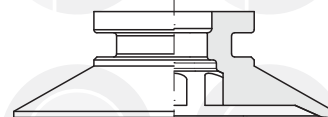

006.0058 - 006.0100
006.0110

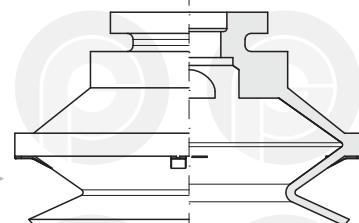

012.0014



PORTAVENTOSE "MINI"

"MINI" SUCKER-HOLDER

PORTE-VENTOUSE "MINI"

SAUGERTRAGER "MINI"

PORTAVENTOSAS "MINI"

Cod. 016.0009

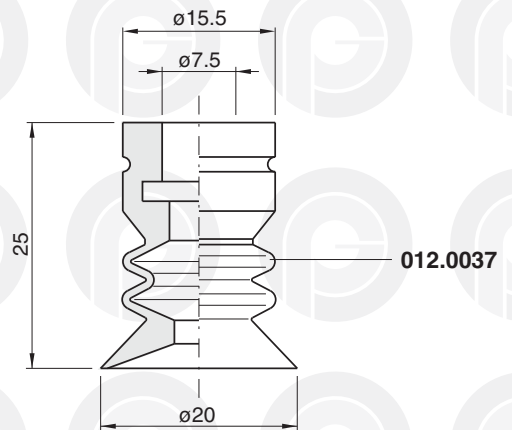
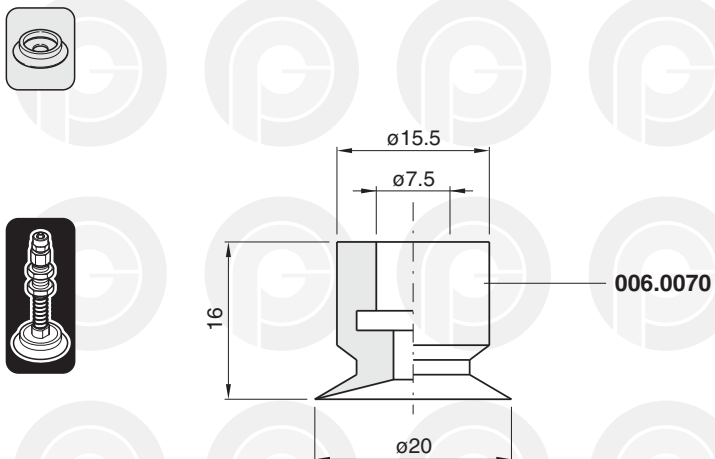
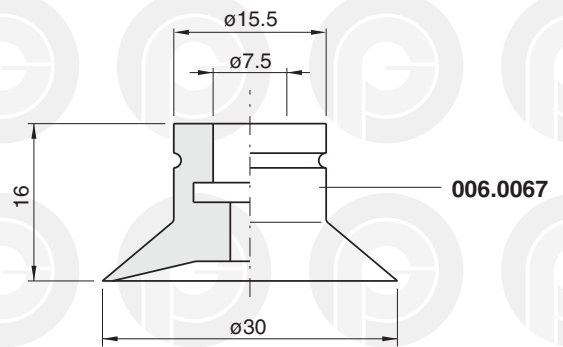
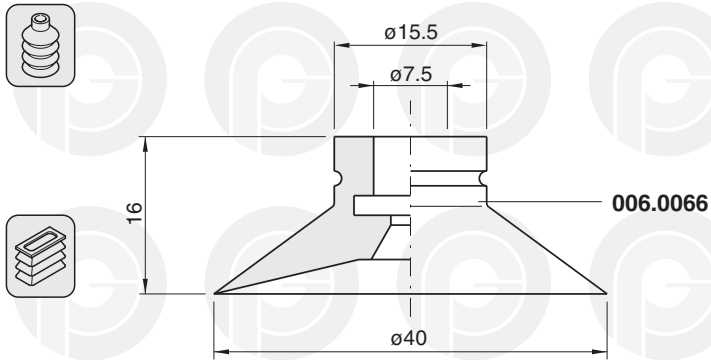
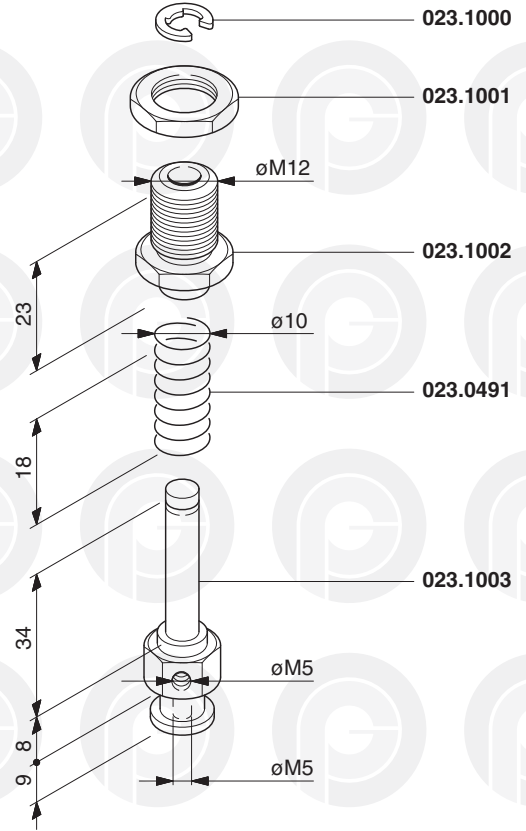
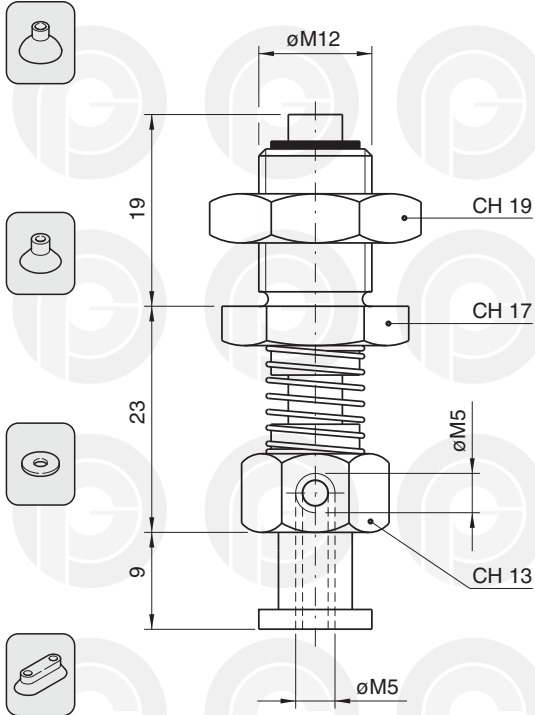

PORTAVENTOSE "MINI"

"MINI" SUCKER-HOLDER

PORTE-VENTOUSE "MINI"

SAUGERTRAGER "MINI"

PORTAVENTOSAS "MINI"

Cod. 016.0001

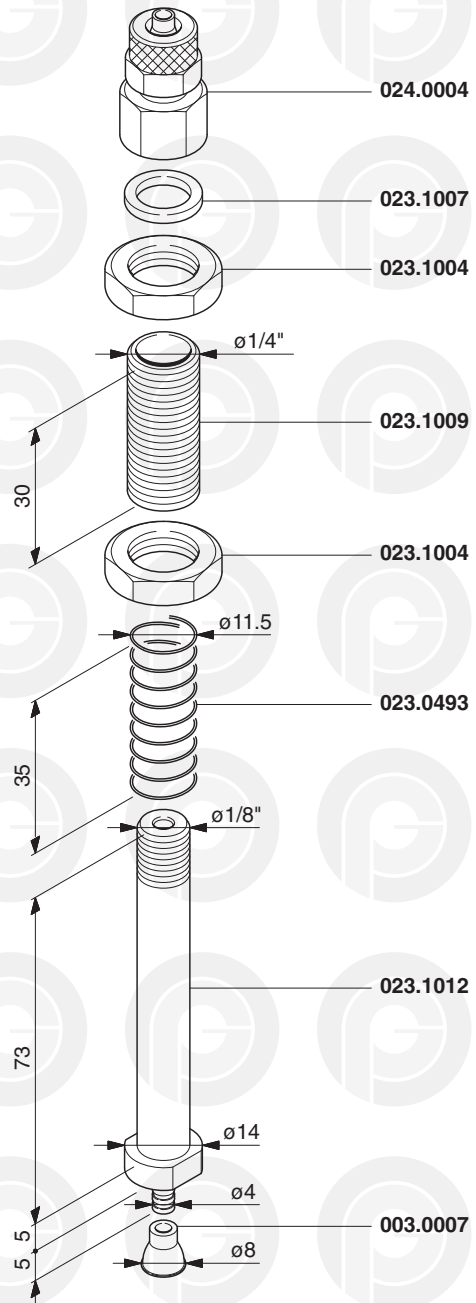
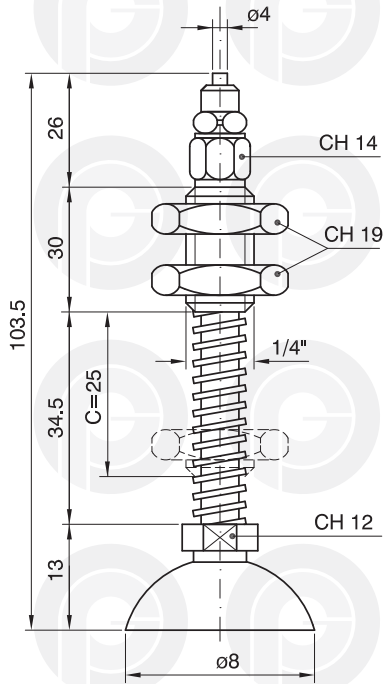

PORTAVENTOSE "MINI"

"MINI" SUCKER-HOLDER

PORTE-VENTOUSE "MINI"

SAUGERTRAGER "MINI"

PORTAVENTOSAS "MINI"



Cod.	D	A	L
016.0002	10	16	106.5
	12	16	106.5
	15	17	107.5
	18	17	107.5
	20	18	108.5
	22	18	108.5

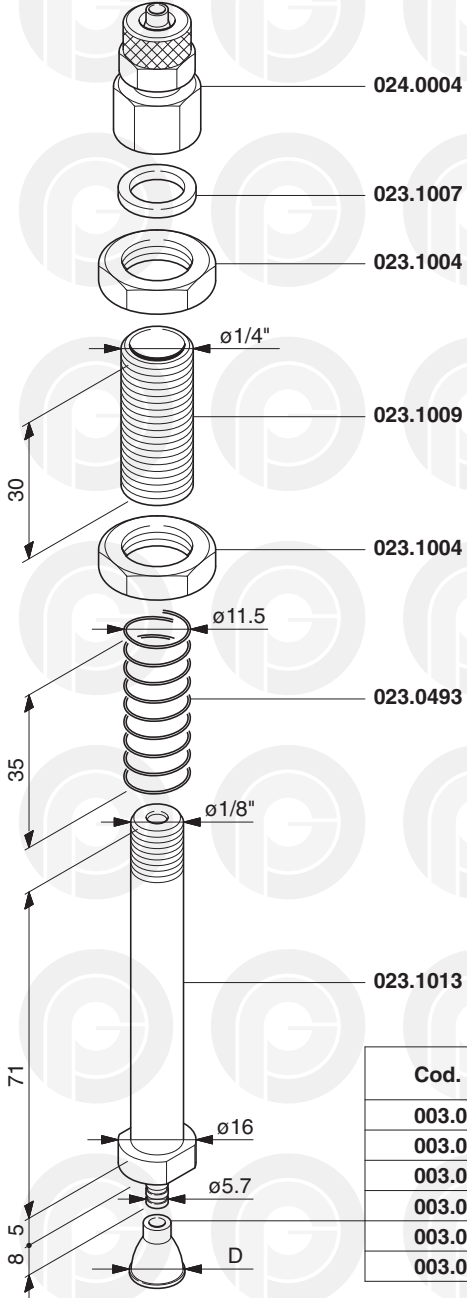
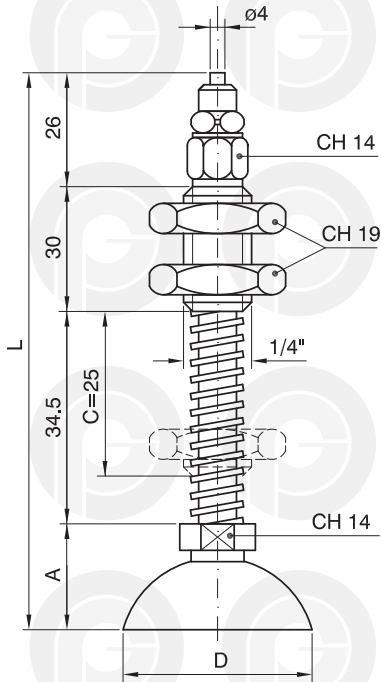

Cod.	D
003.0008	10
003.0009	12
003.0010	15
003.0011	18
003.0012	20
003.0031	22

PORTAVENTOSE "MINI"

"MINI" SUCKER-HOLDER

PORTE-VENTOUSE "MINI"

SAUGERTRAGER "MINI"

PORTAVENTOSAS "MINI"

Cod.	D	A	L
016.0003	25	20	110.5
	30	21	111.5

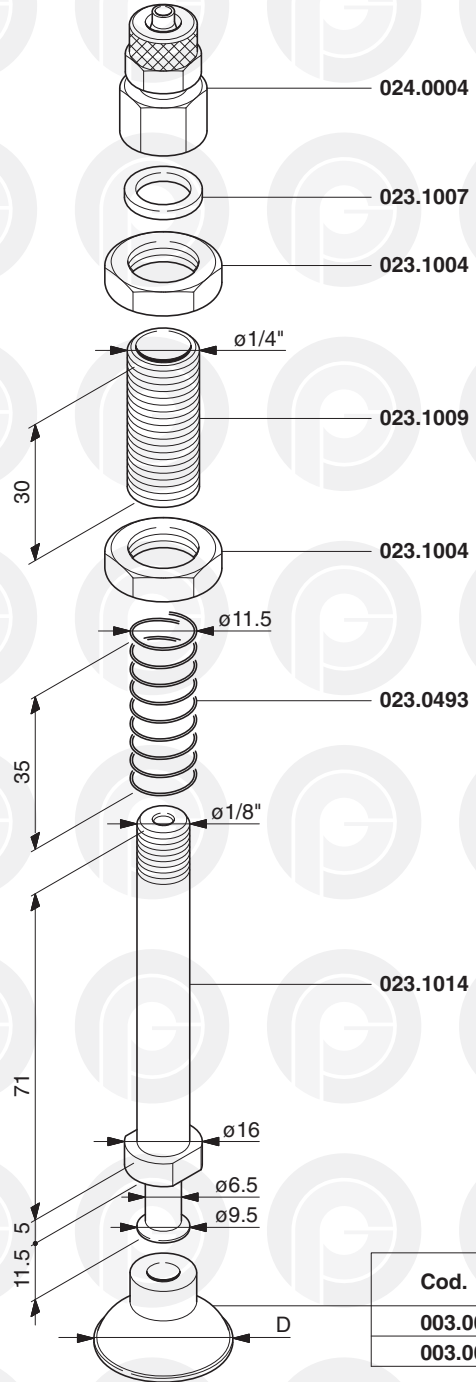
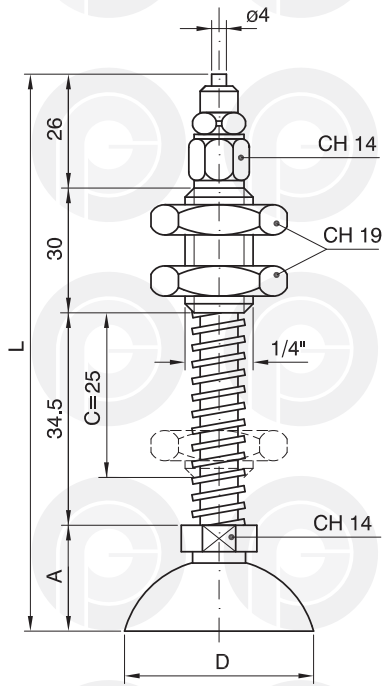

Cod.	D
003.0014	25
003.0016	30

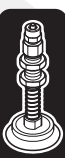

PORTAVENTOSE "MINI"

"MINI" SUCKER-HOLDER

PORTE-VENTOUSE "MINI"

SAUGERTRAGER "MINI"

PORTAVENTOSAS "MINI"

Cod. 016.0004

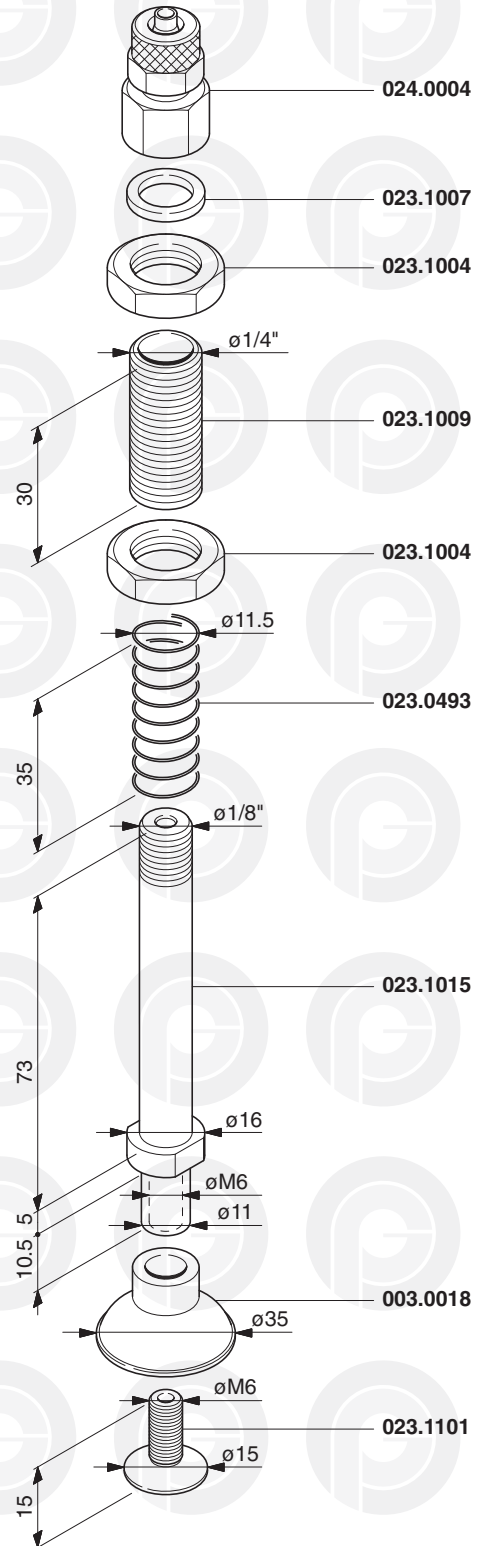
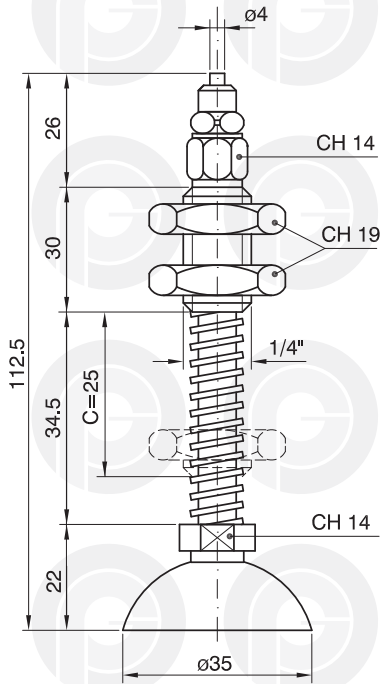

PORTAVENTOSE "MINI"

"MINI" SUCKER-HOLDER

PORTE-VENTOUSE "MINI"

SAUGERTRAGER "MINI"

PORTAVENTOSAS "MINI"

Cod. 016.0005

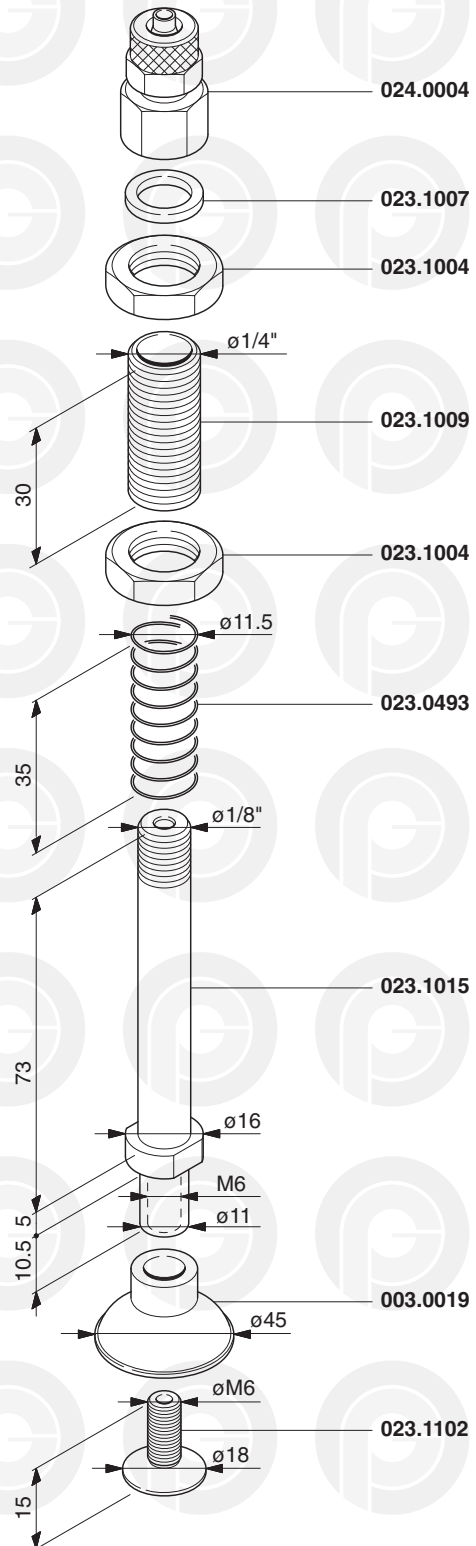
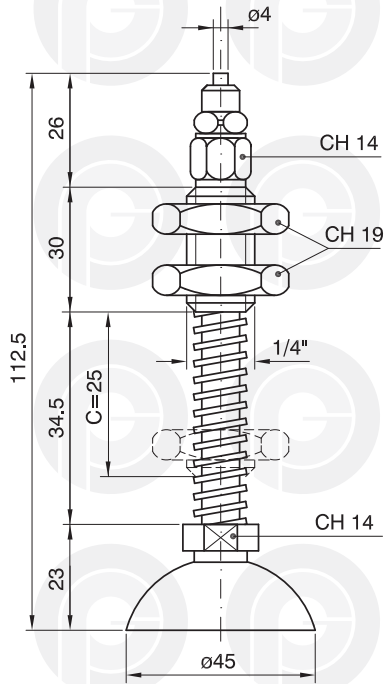

PORTAVENTOSE "MINI"

"MINI" SUCKER-HOLDER

PORTE-VENTOUSE "MINI"

SAUGERTRAGER "MINI"

PORTAVENTOSAS "MINI"

Cod. 016.0101

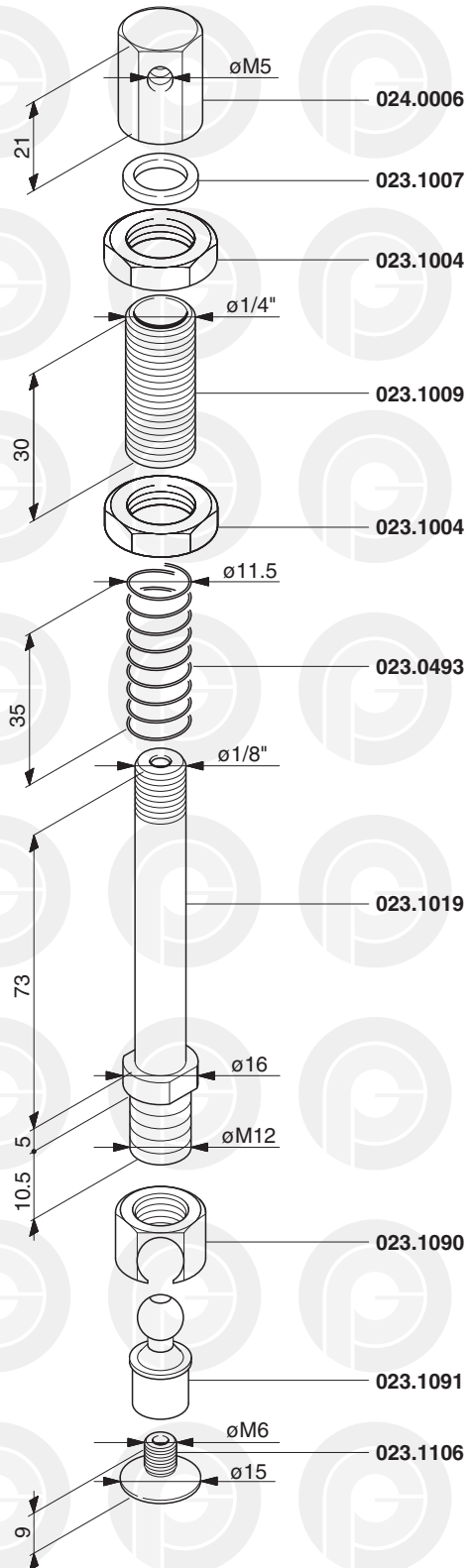
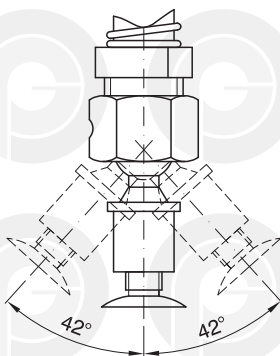
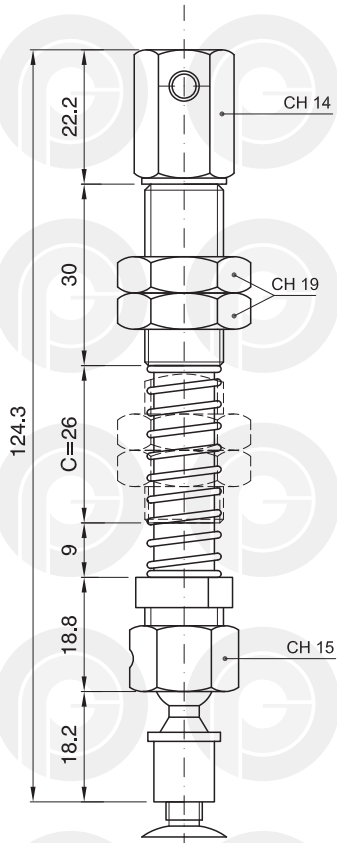

PORTAVENTOSE "MINI" CON TASTATORE

"MINI" SUCKER-HOLDER WITH FEELER
SAUGERTRAGER "MINI" MIT TASTVENTIL

PORTE-VENTOUSE "MINI" AVEC PALPEUR
PORTAVENTOSAS "MINI" CON PALPADOR

Cod.	D	A	L
017.0001	12	11	135
	15	12	136
	18	12	136
	20	13	137
	22	13	137

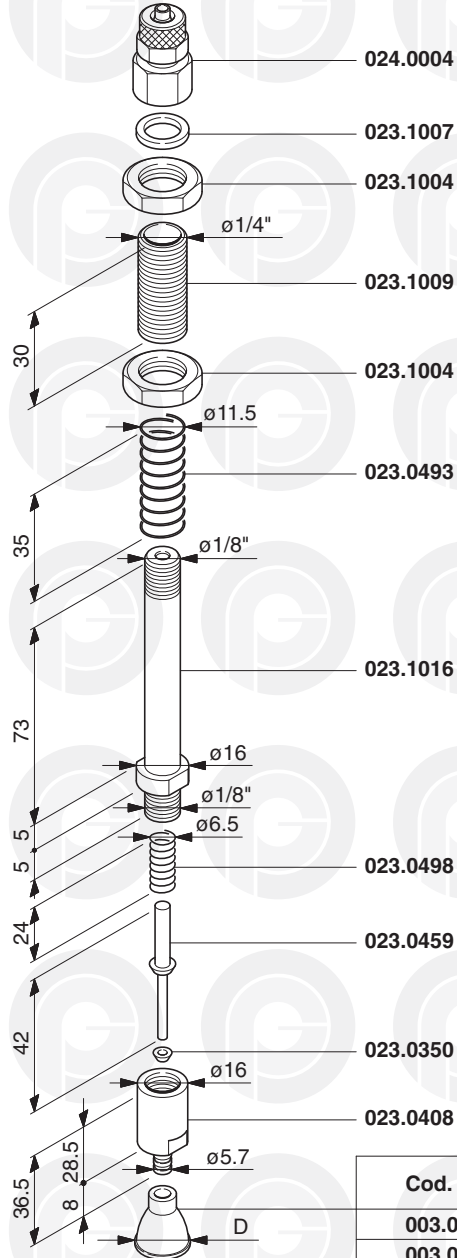
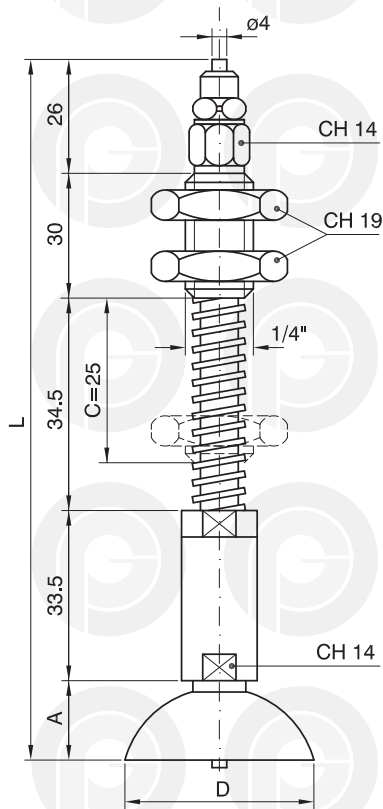

Cod.	D
003.0009	12
003.0010	15
003.0011	18
003.0012	20
003.0031	22



PORTAVENTOSE "MINI" CON TASTATORE

"MINI" SUCKER-HOLDER WITH FEELER
SAUGERTRAGER "MINI" MIT TASTVENTIL

PORTE-VENTOUSE "MINI" AVEC PALPEUR
PORTAVENTOSAS "MINI" CON PALPADOR



Cod.	D	A	L
017.0002	25	15	139
	30	16	140

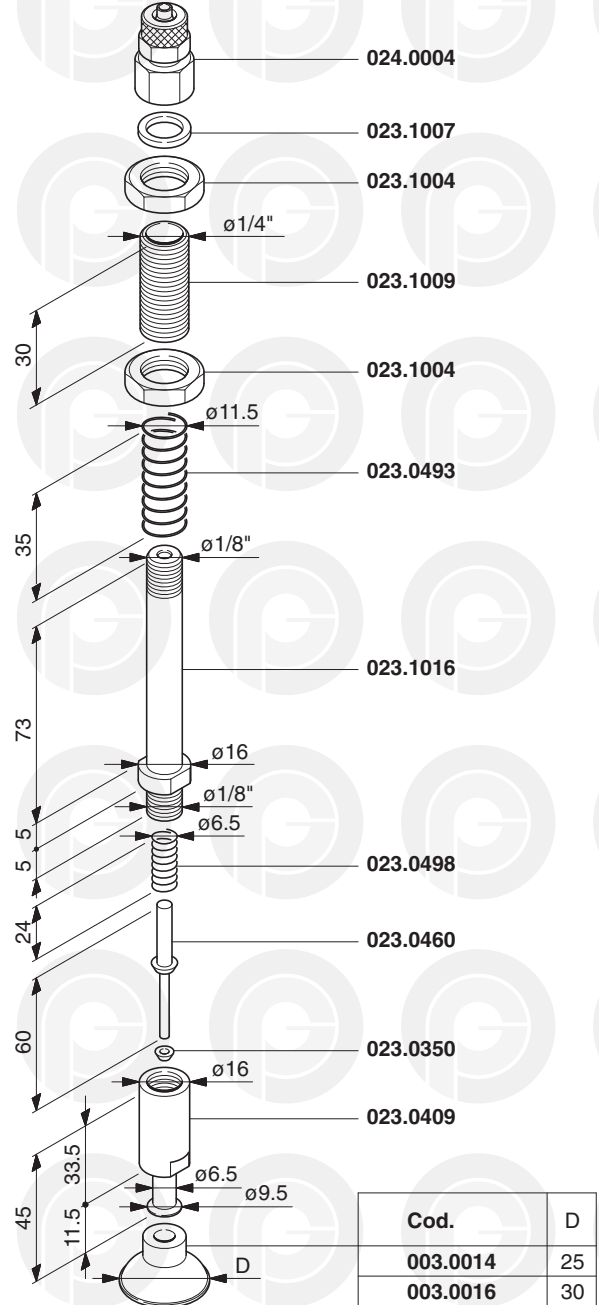
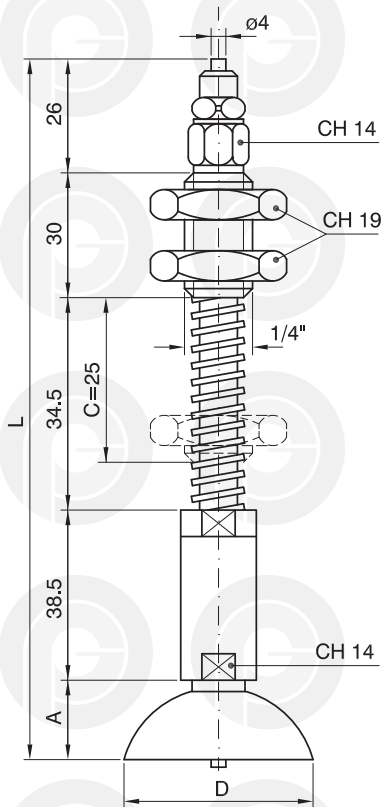

Cod.	D
003.0014	25
003.0016	30

PORTAVENTOSE "MINI" CON TASTATORE

"MINI" SUCKER-HOLDER WITH FEELER
SAUGERTRAGER "MINI" MIT TASTVENTIL

PORTE-VENTOUSE "MINI" AVEC PALPEUR
PORTAVENTOSAS "MINI" CON PALPADOR

Cod. 017.0003

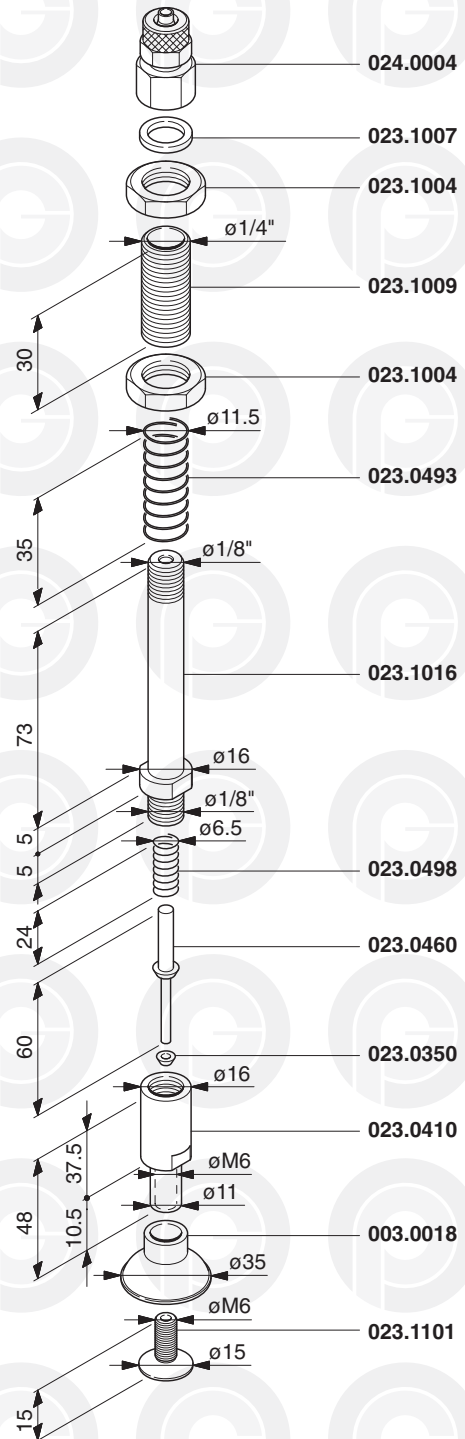
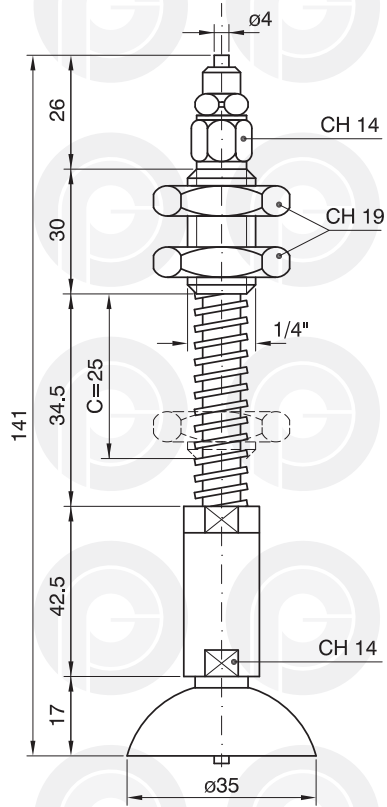

PORTAVENTOSE "MINI" CON TASTATORE

"MINI" SUCKER-HOLDER WITH FEELER
SAUGERTRAGER "MINI" MIT TASTVENTIL

PORTE-VENTOUSE "MINI" AVEC PALPEUR
PORTAVENTOSAS "MINI" CON PALPADOR

Cod. 017.0004

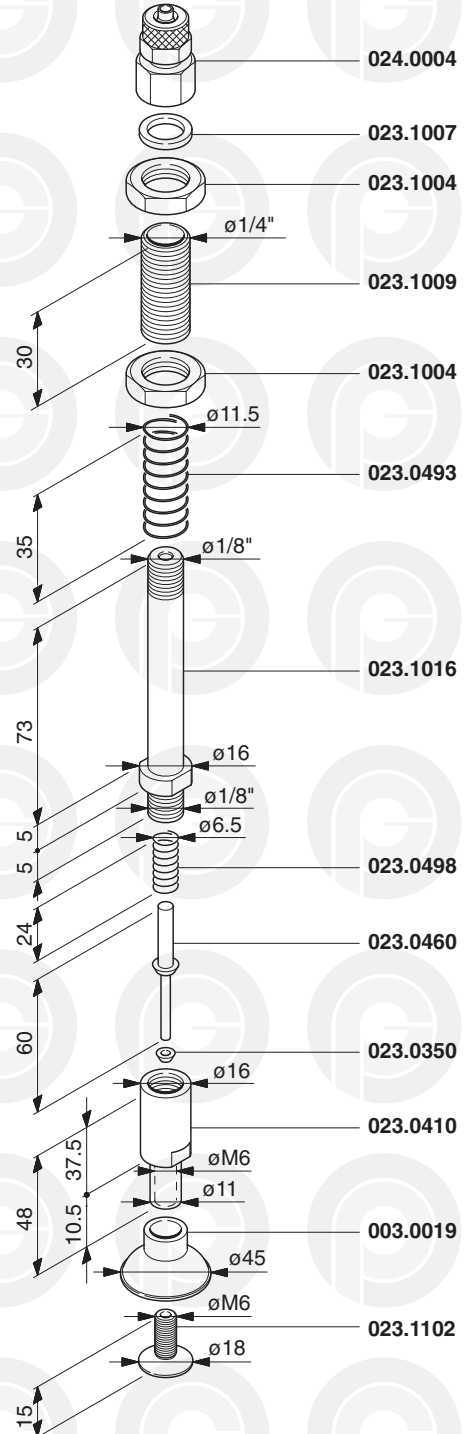
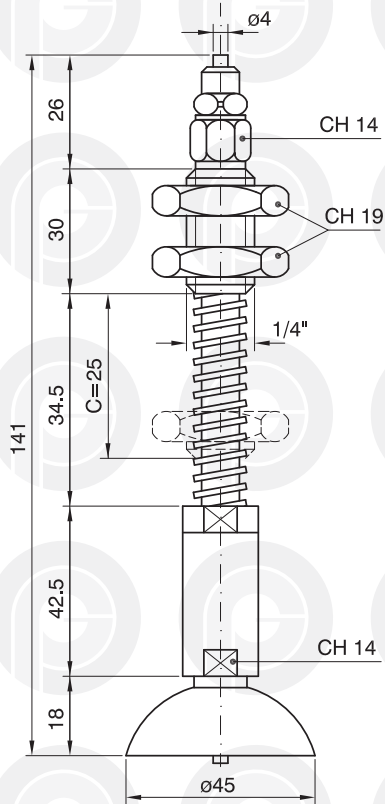

PORTAVENTOSE "STANDARD"

"STANDARD" SUCKER-HOLDER
SAUGERTRAGER "STANDARD"

PORTE-VENTOUSE "STANDARD"
PORTAVENTOSAS "STANDART"

Cod. 022.0001

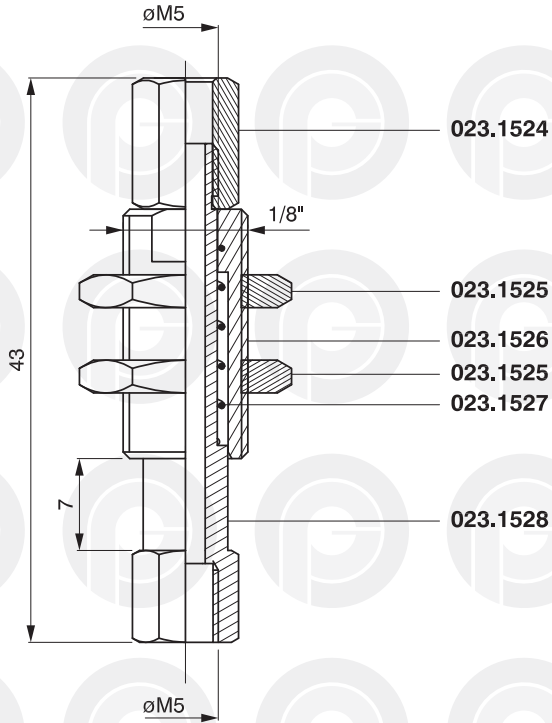

Cod. 022.0002

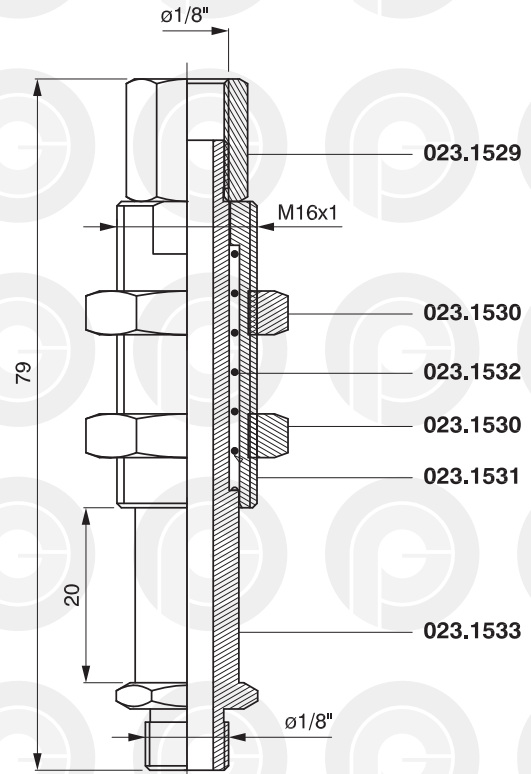

Cod. 022.0003

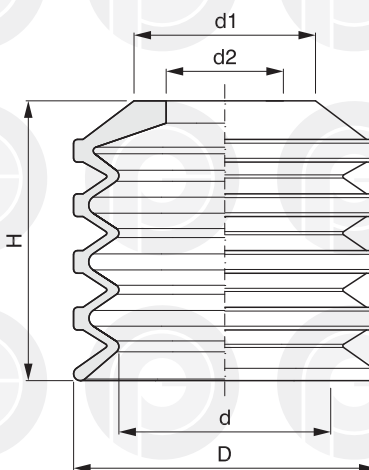
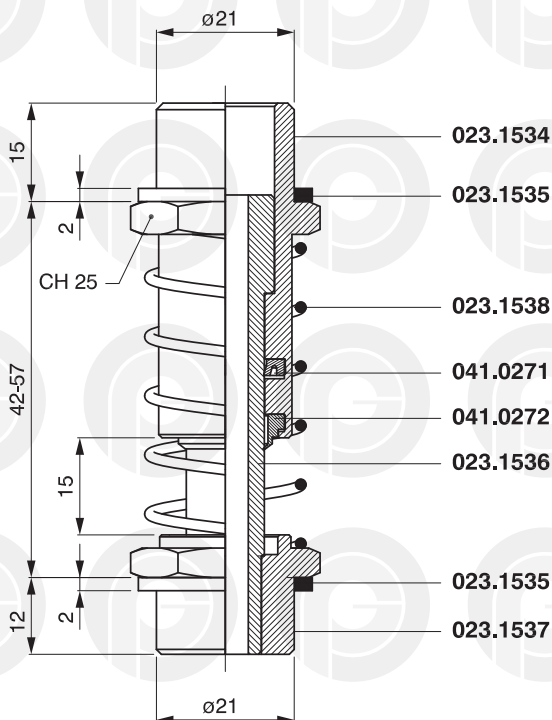

Cod.	D	d	d1	d2	H
023.0390	20	14	14.5	10	19
023.0391	40	28	24	15	37

PORTAVENTOSE "STANDARD"

"STANDARD" SUCKER-HOLDER
SAUGERTRAGER "STANDARD"

PORTE-VENTOUSE "STANDARD"
PORTAVENTOSAS "STANDART"



Cod.	D	A	C	H	L
018.0001	35	27	25	37	133
018.0002	35	27	55	77	173
018.0003	35	27	80	110	206
018.0004	45	28	25	37	134
018.0005	45	28	55	77	174
018.0006	45	28	80	110	207
018.0007	60/65	34	25	37	140
018.0008	60/65	34	55	77	180
018.0009	60/65	34	80	110	213

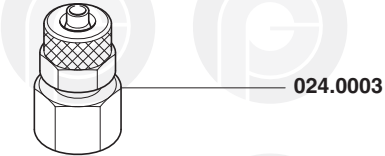
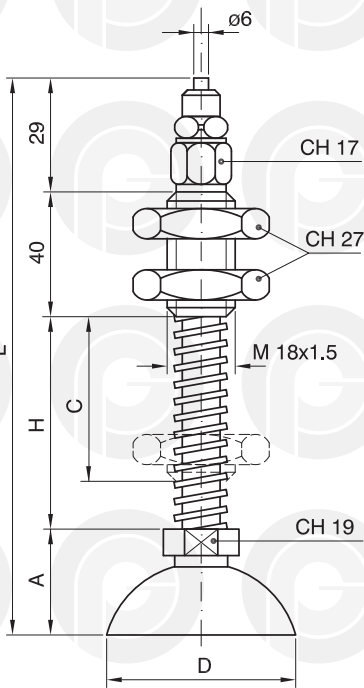

024.0003



023.1008



023.1005

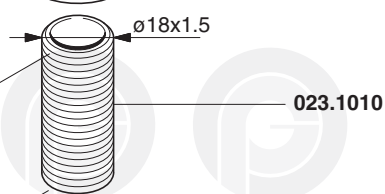

023.1010



023.1005

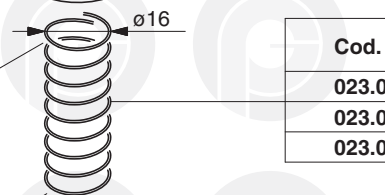

Cod.	H	C
023.0487	38	25
023.0488	80	55
023.0489	110	80

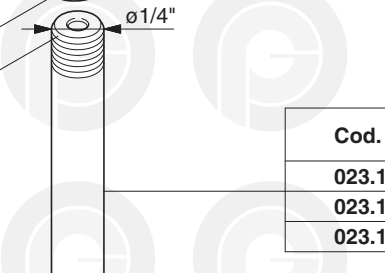

Cod.	H	C
023.1030	89	25
023.1031	130	55
023.1032	162	80



Cod.	D
003.0018	35
003.0019	45
003.0045	60
003.0020	65

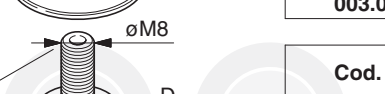

Cod.	D	H
023.1103	15	15
023.1104	18	15
023.1105	25	16

PORTAVENTOSE "STANDARD"

"STANDARD" SUCKER-HOLDER
SAUGERTRAGER "STANDARD"

PORTE-VENTOUSE "STANDARD"
PORTAVENTOSAS "STANDART"

Cod.	C	H	L
018.0010	25	37	156
018.0011	55	77	196
018.0012	80	110	229

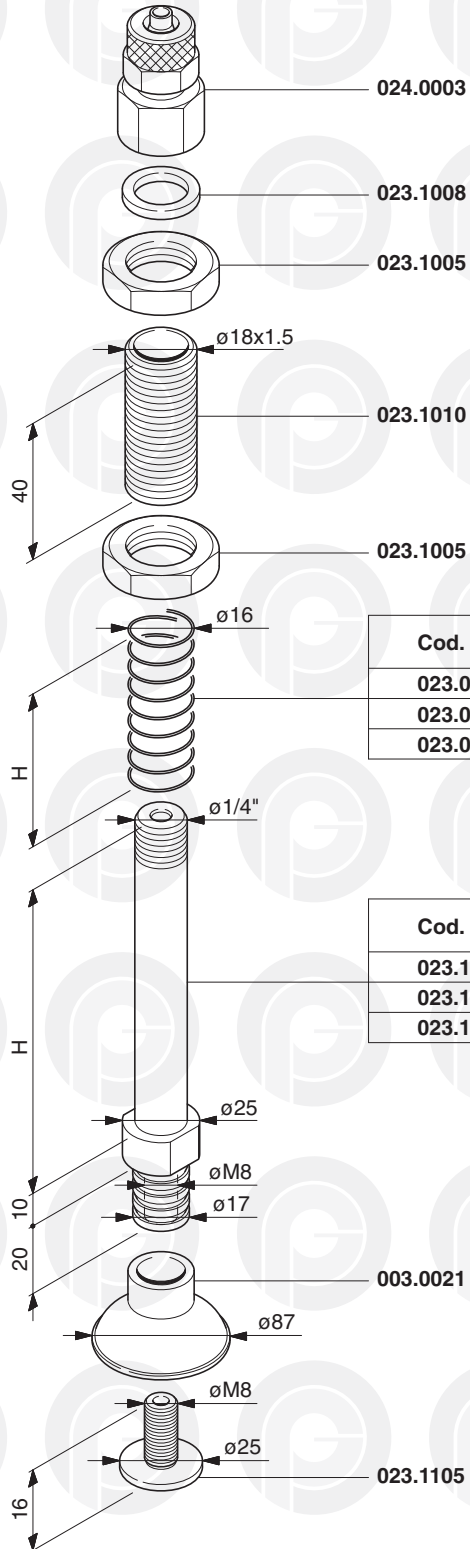
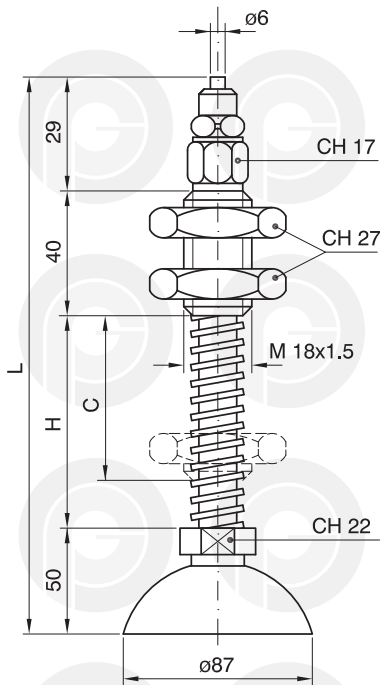

Cod.	H	C
023.0487	38	25
023.0488	80	55
023.0489	110	80

Cod.	H	C
023.1033	89	25
023.1034	130	55
023.1035	162	80



PORTAVENTOSE "STANDARD" CON TASTATORE

"STANDARD" SUCKER-HOLDER WITH FEELER
SAUGERTRAGER "STANDARD" MIT TASTVENTIL

PORTE-VENTOUSE "STANDARD" AVEC PALPEUR
PORTAVENTOSAS "STANDART" CON PALPADOR



Cod.	D	A	C	H	L
019.0001	35	17	25	37	170
019.0002	35	17	55	77	210
019.0003	35	17	80	110	243
019.0004	45	18	25	37	171
019.0005	45	18	55	77	211
019.0006	45	18	80	110	244
019.0007	60/65	24	25	37	177
019.0008	60/65	24	55	77	217
019.0009	60/65	24	80	110	250

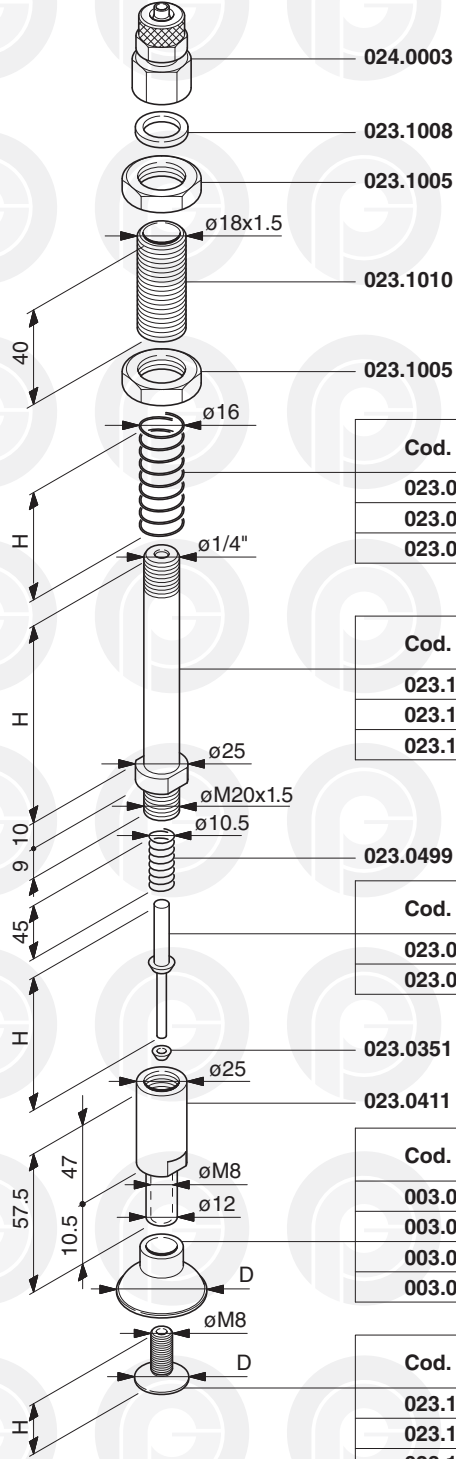
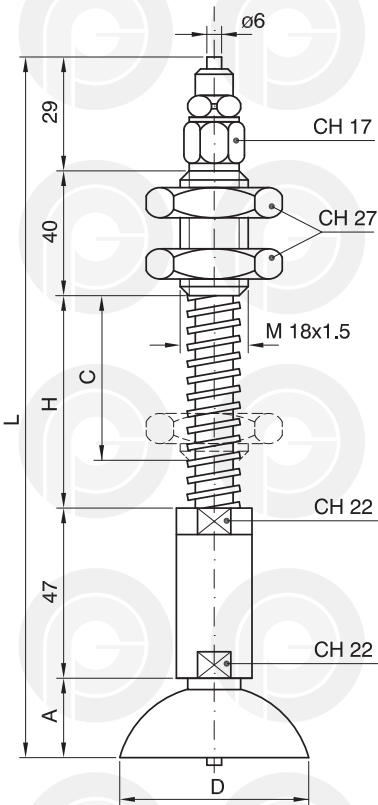

Cod.	H	C
023.0487	38	25
023.0488	80	55
023.0489	110	80

Cod.	H	C
023.1039	89	25
023.1040	130	55
023.1041	162	80

Cod.	D	H
023.0450	35-45	50
023.0451	65	55

Cod.	D
003.0018	35
003.0019	45
003.0045	60
003.0020	65

Cod.	D	H
023.1103	15	15
023.1104	18	15
023.1105	25	16

PORTAVENTOSE "STANDARD" CON TASTATORE

"STANDARD" SUCKER-HOLDER WITH FEELER
SAUGERTRAGER "STANDARD" MIT TASTVENTIL

PORTE-VENTOUSE "STANDARD" AVEC PALPEUR
PORTAVENTOSAS "STANDART" CON PALPADOR

Cod.	C	H	L
019.0010	25	37	193
019.0011	55	77	233
019.0012	80	110	266

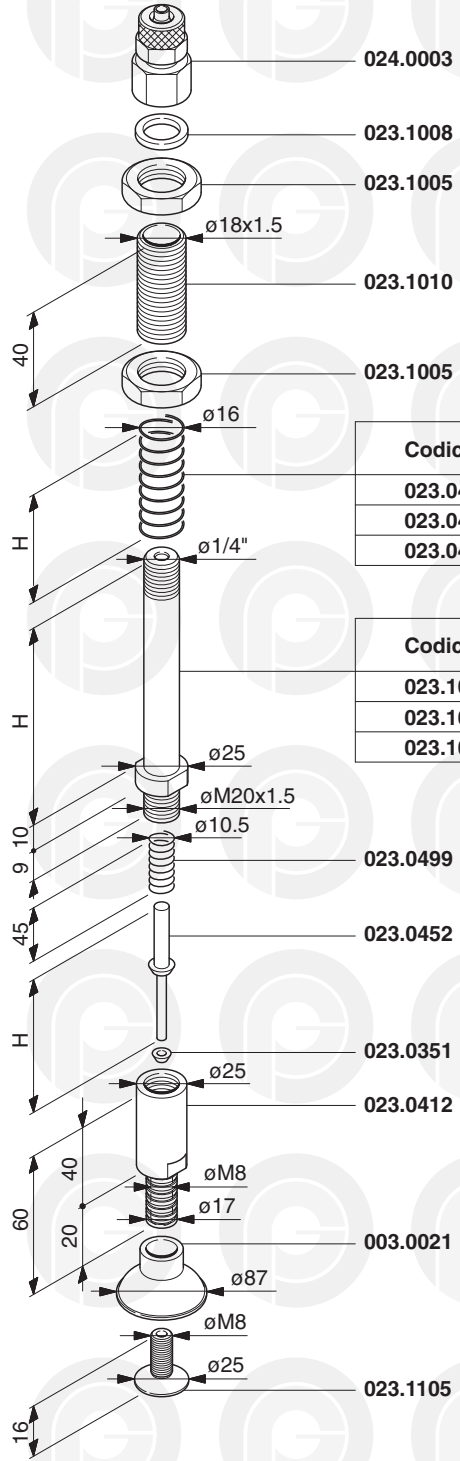
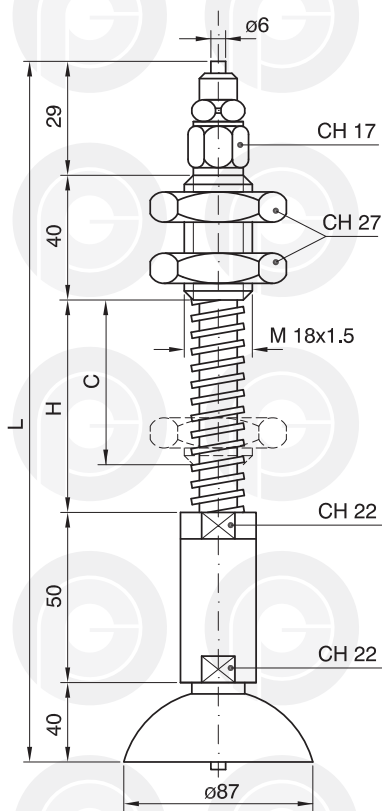

Codice	H	C
023.0487	38	25
023.0488	80	55
023.0489	110	80

Codice	H	C
023.1039	89	25
023.1040	130	55
023.1041	162	80

PORTAVENTOSE "STANDARD"

"STANDARD" SUCKER-HOLDER
SAUGERTRAGER "STANDARD"

PORTE-VENTOUSE "STANDARD"
PORTAVENTOSAS "STANDART"



Cod.	D	C	H	L
018.0019	65	25	37	132
018.0020	65	55	77	172
018.0021	65	80	110	205
018.0019	90	25	37	132
018.0020	90	55	77	172
018.0021	90	80	110	205
018.0019	120	25	37	132
018.0020	120	55	77	172
018.0021	120	80	110	205

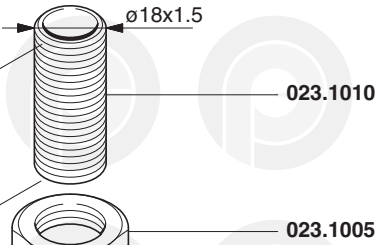
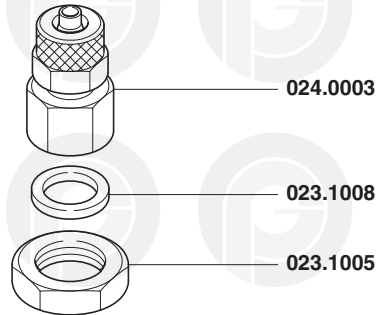
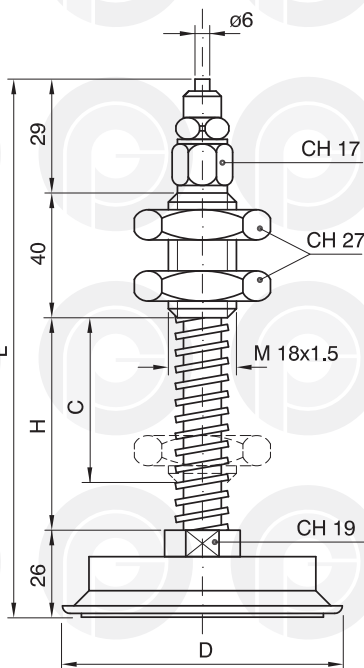

Cod.	H	C
023.0487	38	25
023.0488	80	55
023.0489	110	80

Cod.	H	C
023.1036	89	25
023.1037	130	55
023.1038	162	80

Cod.	H	D
023.05002	10	44
023.05012	11	63
023.05023	11	92

Cod.	D
010.0001	65
010.0002	90
010.0003	120

PORTAVENTOSE "STANDARD" CON TASTATORE

"STANDARD" SUCKER-HOLDER WITH FEELER
SAUGERTRAGER "STANDARD" MIT TASTVENTIL

PORTE-VENTOUSE "STANDARD" AVEC PALPEUR
PORTAVENTOSAS "STANDART" CON PALPADOR

Cod.	C	H	L
019.0013	25	37	135
019.0014	55	77	175
019.0015	80	110	208

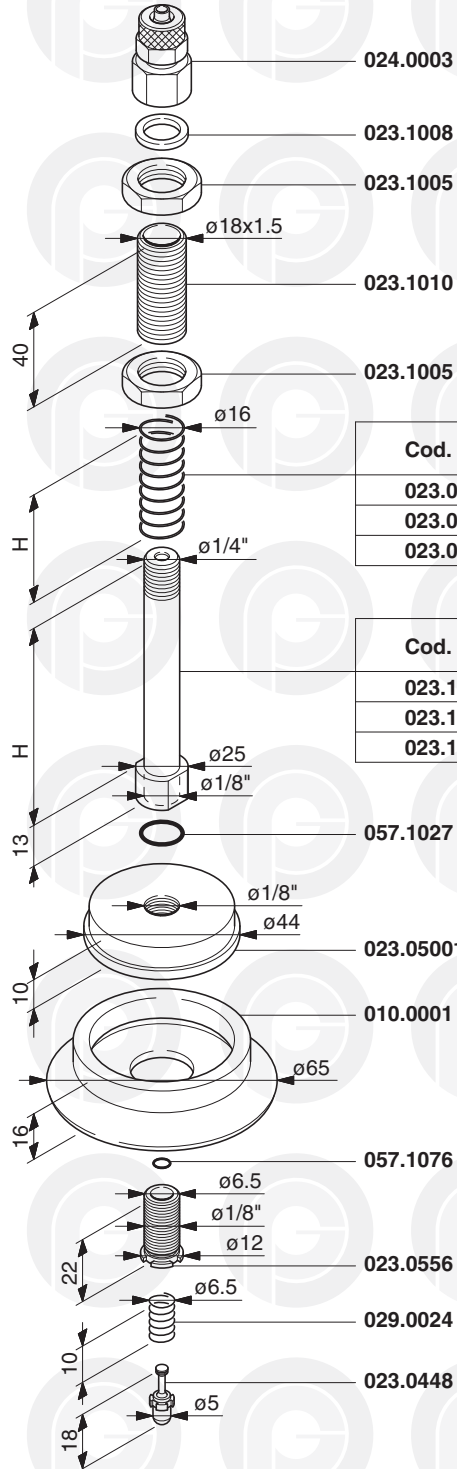
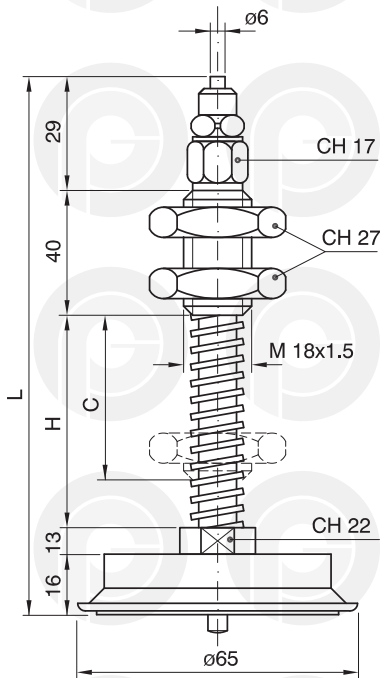

Cod.	H	C
023.0487	38	25
023.0488	80	55
023.0489	110	80

Cod.	H	C
023.1042	89	25
023.1043	130	55
023.1044	162	80



PORTAVENTOSE "STANDARD" CON TASTATORE

"STANDARD" SUCKER-HOLDER WITH FEELER
SAUGERTRAGER "STANDARD" MIT TASTVENTIL

PORTE-VENTOUSE "STANDARD" AVEC PALPEUR
PORTAVENTOSAS "STANDART" CON PALPADOR



Cod.	D	C	H	L
019.0016	90	25	37	164
019.0017	90	55	77	204
019.0018	90	80	110	237
019.0019	120	25	37	164
019.0020	120	55	77	204
019.0021	120	80	110	237

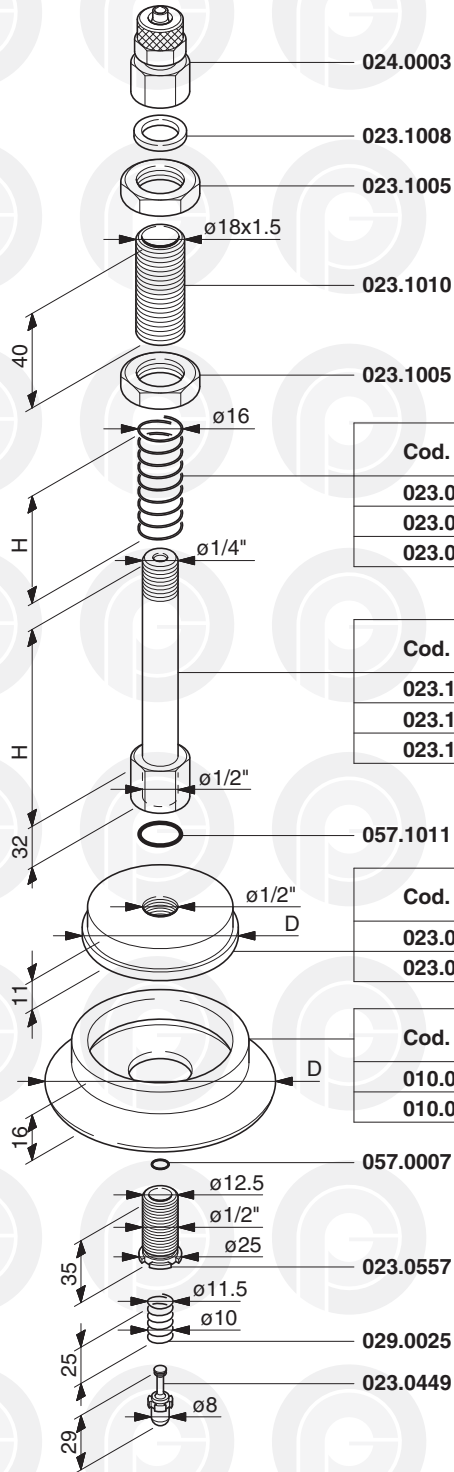
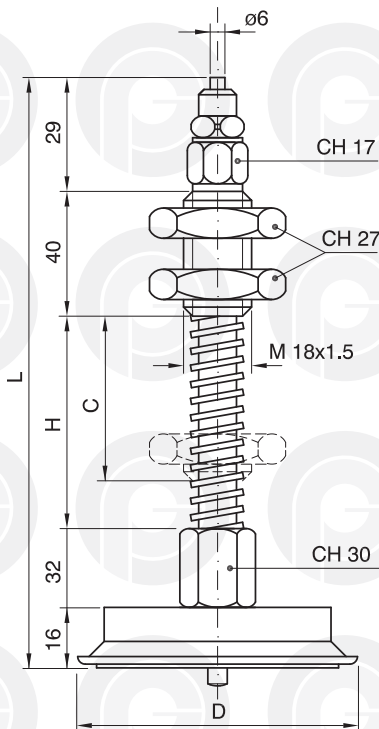

Cod.	H	C
023.0487	38	25
023.0488	80	55
023.0489	110	80

Cod.	H	C
023.1045	89	25
023.1046	130	55
023.1047	162	80

Cod.	D
023.05011	63
023.05021	92

Cod.	D
010.0002	90
010.0003	120

PORTAVENTOSE "MAGNUM"

"MAGNUM" SUCKER-HOLDER
SAUGERTRAGER "MAGNUM"

PORTE-VENTOUSE "MAGNUM"
PORTAVENTOSAS "MAGNUM"

Cod. 021.0001

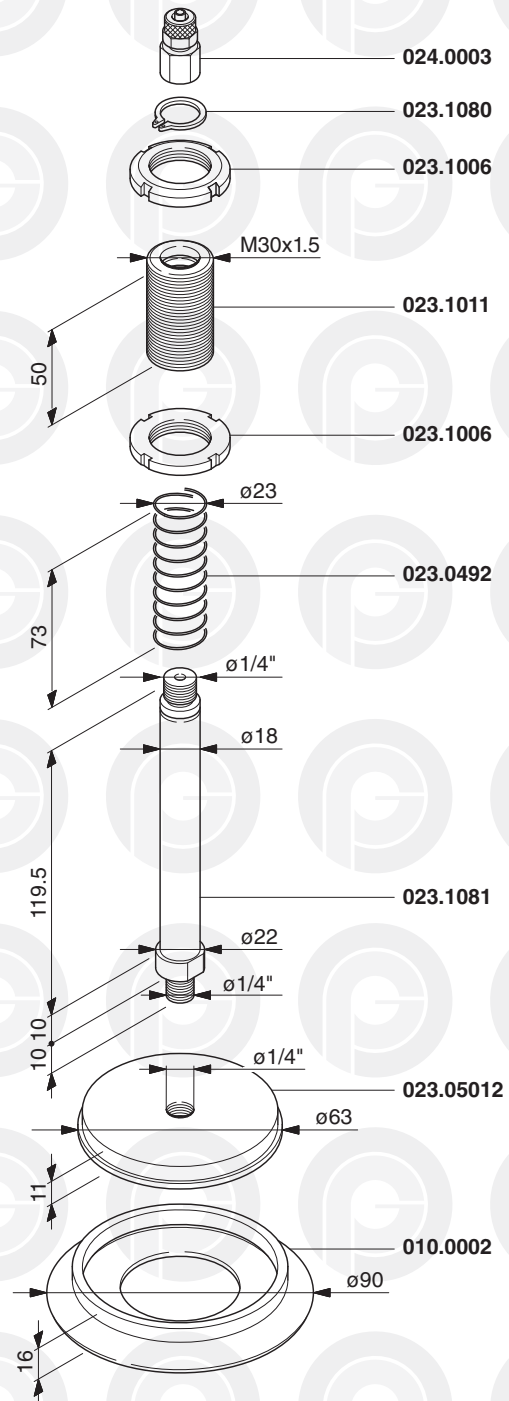
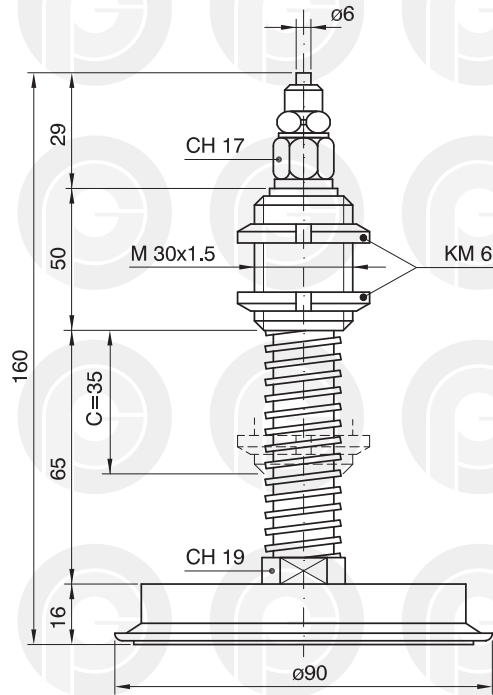

PORTAVENTOSE "MAGNUM"

"MAGNUM" SUCKER-HOLDER
SAUGERTRAGER "MAGNUM"

PORTE-VENTOUSE "MAGNUM"
PORTAVENTOSAS "MAGNUM"



Cod.	D	A	L
021.0002	120	16	176
	160	23	183

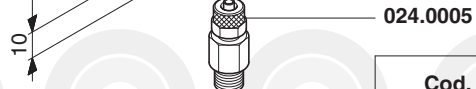
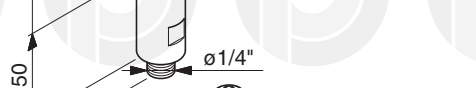
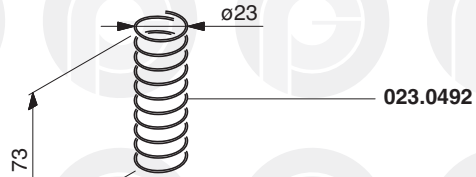
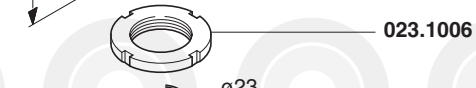
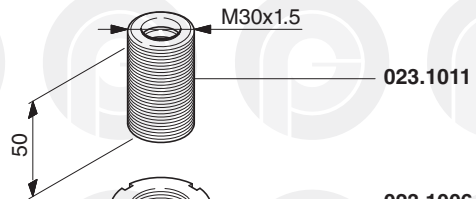
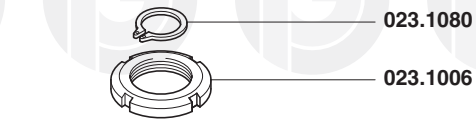
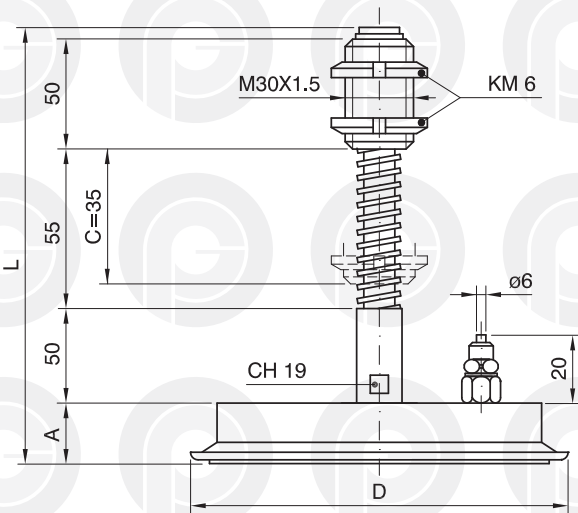
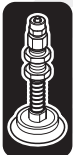

Cod.	D	H
023.05022	92	11
023.05032	127	15

Cod.	D	H
010.0003	120	16
010.0004	160	23

PORTAVENTOSE "MAGNUM"

"MAGNUM" SUCKER-HOLDER
SAUGERTRAGER "MAGNUM"

PORTE-VENTOUSE "MAGNUM"
PORTAVENTOSAS "MAGNUM"

Cod. 021.0003

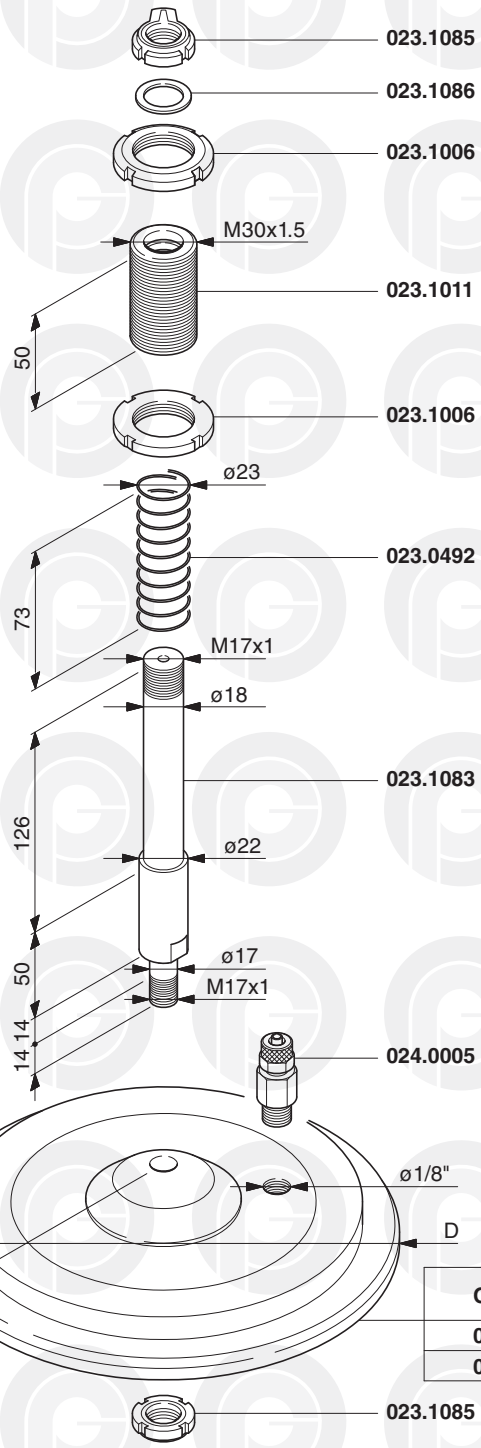
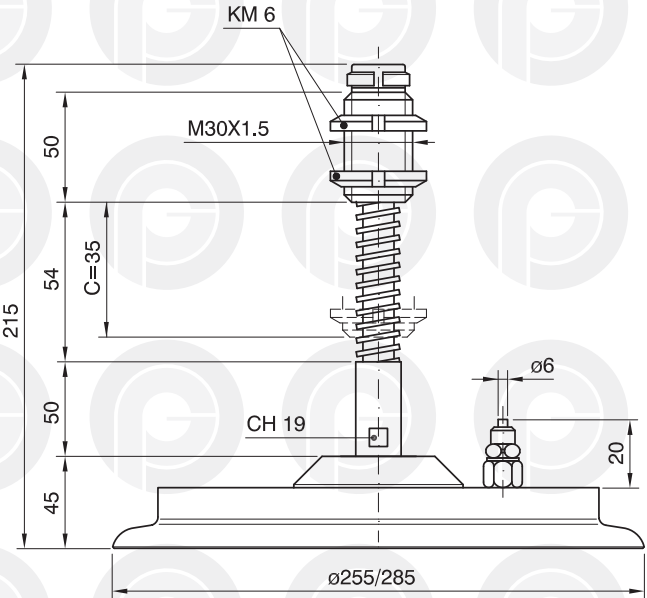

Cod.	D
011.0005	255
011.0006	285

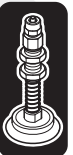

PORTAVENTOSE CON TASTATORE

SUCKER-HOLDER WITH FEELER
SAUGERTRAGER MIT TASTVENTIL

PORTE-VENTOUSE AVEC PALPEUR
PORTAVENTOSAS CON PALPADOR

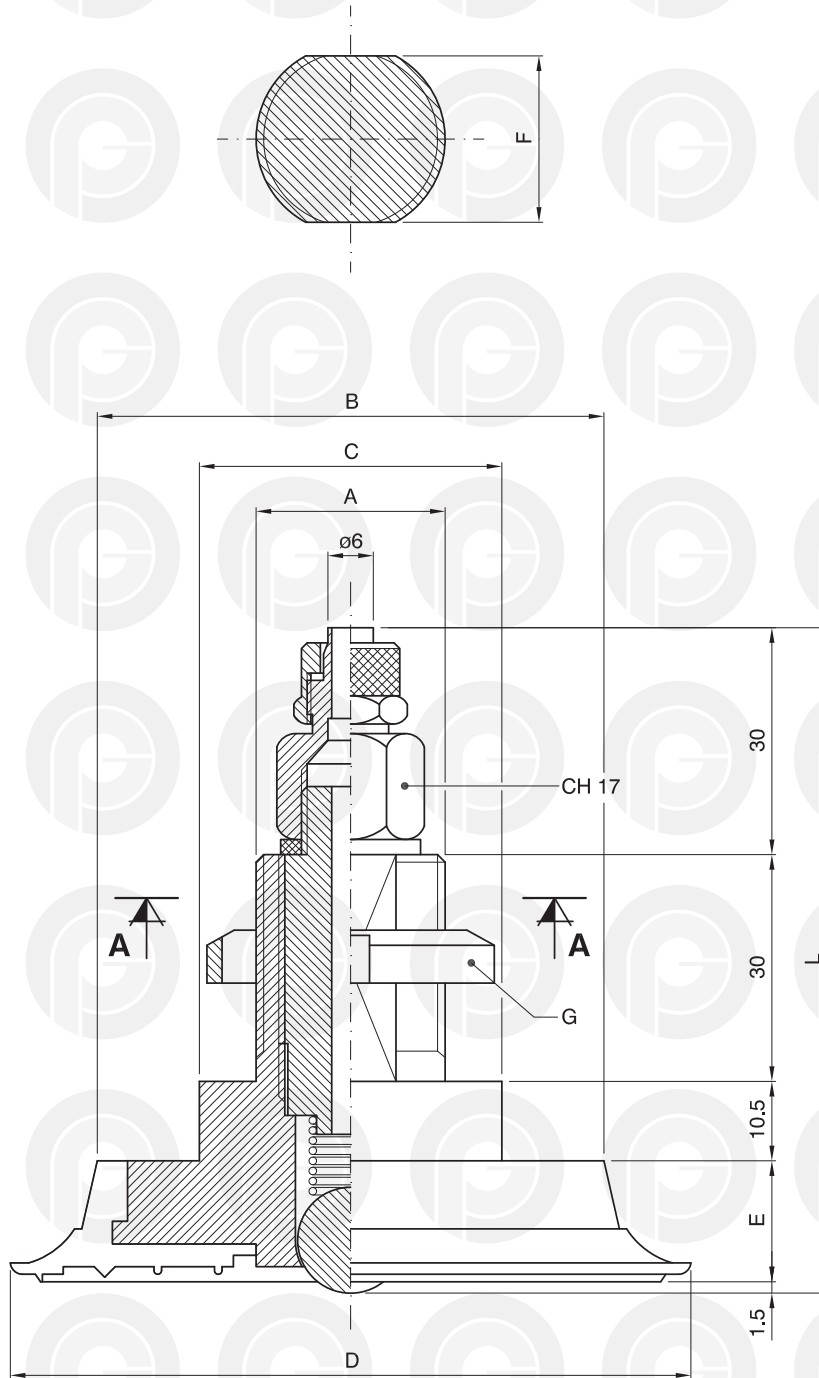

Cod.	A	B	C	D	E	F	L	G
018.1001	25x1.5	50	40	65	16	22	89	KM 5
018.1002	25x1.5	67	40	90	16	22	89	KM 5
018.1003	25x1.5	97	40	120	16	22	89	KM 5
018.1004	35x1.5	135	80	160	23	32	93	KM 7